

WASHROOM & MAINTENANCE

A			G		
Ash Trays.....	344		Goggles, Safety.....	343	
Automatic Faucet Kits.....	316-317		Grab Bars.....	310	
B			Grabbers.....	331	
Baby Changing Stations.....	305		Graffiti Remover.....	348	
Bars.....			Grates, Smith Floor Drain.....	313	
Grab.....	310		Grease Trap Treatment.....	350	
Towel.....	310		Grout Coating.....	351	
Belts, Back Support.....	343		H		
Brooms.....			Hand and Nail Cleaning Items.....	334	
Lobby.....	318		Hand Dryers.....	296-297	
Heads/Scrubbers.....	319		Handles.....		
Organizers.....	324-325		Trash Bin (Sani-Grab).....	336	
Brushes.....	325-326, 334		Door.....	308	
Buckets.....	321, 323, 327, 329		Hardware, Stall.....	306-310	
C			Hooks.....	307	
Carbon Remover.....	348		Hoses and Accessories.....	343	
Carpet/Floor.....			I		
Dryer.....	337		Inspection Kit, Handheld.....	333	
Sweeper.....	318		K		
Cart, Laundry.....	335		Keys, Dispenser.....	300	
Casters.....			Kits.....		
Rubbermaid® Mop Buckets.....	321-322		Automatic Faucet.....	316	
Rubbermaid® "Universal Drum" Dolly.....	335		Diaphragm Repair.....	315	
Rubbermaid® Utility Carts.....	335		Flush Handle Repair.....	315	
Caution/Wet Floor Signs.....	337		Handheld Inspection.....	333	
Changing Station Liners.....	304		Lighted Exit Sign Conversion.....	338	
Child Care Stations.....	305		Partition Anchor.....	307	
Coat Hooks.....	307		Vacuum Breaker Repair.....	315	
Cleaners.....	347-351		Window Cleaning.....	327-328	
Cleaning Tool Holders.....	324-325		Koala Kare® Products.....		
D			Baby Changing Stations.....	305	
Deliming Spring.....	349		Child Protection Seat.....	304	
Deodorizers.....	311, 312		Sanitary Liners.....	304	
Dispensers.....			L		
Chemical Pump.....	350		Laundry Cart.....	335	
Hand Sanitizer.....	292		Light Bulb Changers.....	332	
Keys.....	300		Litter Compacting Tool.....	336	
Paper Towel.....	298-302		Lubricant, Food Grade.....	351-352	
Seat Cover.....	291		M		
Soap.....	292-295		Magnetic Trash Lids.....	336	
Tampon and Napkin.....	303		Microwipes.....	333	
Toilet Tissue and Parts.....	288-291		Mirrors.....		
Disposals, Tampon and Napkin.....	303		Unbreakable.....	311	
Dolly, Brute®.....	335		Vandal Proof.....	311	
Door Handles.....	308		Mop and Broom.....		
Drain.....			Buckets.....	321, 323	
Deodorizer.....	350		Bucket Fill Hose.....	322	
Grates, Floor (Smith).....	313		Head and Holders.....	319, 322	
Uncloggers.....	312		Organizers.....	324-325	
Dryers.....			Wringer Parts.....	322	
Floor and Carpet.....	337		O		
Hand.....	296-297		Odor Control Units.....	313	
Dusters.....	328		Oil, Food Grade.....	351-352	
Dustpans.....	318		P		
E			Paint, Spray.....	346	
Epoxy Putty.....	345		Paper, Towel Dispensers.....	298-302	
F			Plungers.....	312	
Fasteners.....			Polish and Polishing Cloths.....	347	
One-way.....	308		Pumice Stick.....	325	
Wing-It™.....	304, 308		Putty, Epoxy.....	345	
Faucets.....	316-317		R		
Floor/Carpet.....			Removers.....		
Dryer.....	337		Bulb.....	332	
Sweeper.....	318		Carbon.....	348	
Flush Valve.....			Chewing Gum.....	348	
Repair Kits.....	315		Graffiti.....	348	
Replacement Parts.....	314-315		Scale.....	349	
Sloan.....	314-315		Rubbermaid® Products.....	313, 321-322, 335, 344	
Food Grade Grease.....	351-352				
S					
Safety.....					
Chain with Sign.....	337				
Cones.....	337				
Goggles.....	343				
Sani-Grab Trash Bin Handle.....	336				
Scale Removers.....	349				
Scrapers.....	331				
Screens, Urinal.....	311				
Scrubbers.....					
Floor.....	319, 326				
Hard Surface.....	325-326				
Walnutpad®.....	325				
Sealants.....	345				
Seat Cover Dispensers.....	291				
Sign Conversion Kit, Lighted Exit.....	336				
Signs.....	337-342				
Soap Dispensers.....	292-295				
Sponges.....	325-326, 329				
Spray.....					
Bottle Belt.....	333				
Bottle Rack.....	323				
Bottles.....	323, 333				
Paint.....	346				
Silicone.....	352				
Zinc Galvanize.....	346				
Squeegees.....	326-327, 329				
Stall Hardware.....	306-310				
Strikes, Stall Door.....	309				
Sweeper, Floor/Carpet.....	318				
T					
Tampon and Napkin Dispensers/Disposals.....	303				
Thermostat Cover.....	338				
Toilet.....					
Brushes.....	312				
Flush Handles.....	315				
Flapper.....	315				
Flush Valves.....	314-315				
Partitions.....	306				
Seat Cover Dispensers.....	291				
Seats.....	291				
Tissue Dispensers.....	288-291				
Towel.....					
Absorber®.....	323				
Bar.....	310				
Dispensers.....	298-302				
Trash.....					
Bins.....	336				
Bin Handle (Sani-Grab).....	336				
Compacting Tool.....	336				
Lids.....	336				
Trolleys.....	335				
U					
Unger® Products.....	312, 321-322, 324, 328-333				
Urinal.....					
Flush Valves.....	314-315				
Partitions.....	306				
Screens.....	311				
W					
Wall Fastener, Wing-It™.....	304, 308				
Walnutpad® Scrubbing Pad and Sponge.....	325				
Wet Floor Signs.....	337				
Window Cleaners.....	351				
Wipes.....	333				

TOILET TISSUE DISPENSERS



1



2



3



4

RESERVE ROLL TOILET TISSUE DISPENSERS by BOBRICK

- Holds 2 rolls
- Locking hinged door
- Theft resistant
- Stainless steel with satin finish

1. **No. 141-2022** Recess mounted
 - 11½" H x 6¼" W x 3¼" D (290mm x 160mm x 83mm) rough wall opening
2. **No. 141-2021** Surface mounted
 - 10½" H x 5⅞" W x 5⅞" D (267mm x 149mm x 143mm)

PARTS

No. 141-2025 Cylinder lock and key

- 1¼" (32mm) latch

No. 141-2060 Cylinder lock and key

- 1⅞" (27mm) latch

No. 141-1161 Key

No. 141-2075 Knob latch

- For use with toilet tissue dispenser (No. 141-2021)

Note: Latch is used in place of key lock

RESERVE ROLL TOILET TISSUE DISPENSERS by BRADLEY

- Holds 2 rolls
- Second roll is released when the first is empty
- Locking hinged door
- Stainless steel

3. **No. 141-1089** Recess mounted
 - 10½" high x 5¾" wide (267mm x 146mm) rough wall opening
4. **No. 141-1088** Surface mounted
 - 10⅜" L x 5⅞" W x 5⅞" D (264mm x 141mm x 132mm)

PARTS

No. 141-1022 Replacement roller

No. 141-1169 Cylinder lock and cam

No. 141-1150 Key for cylinder lock

- Pack of 5



RESERVE ROLL TOILET TISSUE DISPENSER by BOBRICK

No. 141-1164

- Holds 2 rolls
- Second roll is concealed and easily shifts into place when the first roll is depleted
- Quick refill access and hidden locking device
- 13⅞" H x 6¼" W x 6⅞" D (333mm x 159mm x 175mm)
- High-impact plastic

No. 141-2014 Key



RESERVE ROLL TOILET TISSUE DISPENSER by SAN JAMAR®

No. 150-5012



- Holds 2 rolls
- Second roll easily slides into dispensing position whether mounted vertically or horizontally
- Can accommodate industrial size rolls
- 10¼" H x 6" W x 6½" D (260mm x 152mm x 165mm)
- Bright chrome finish

TOILET TISSUE DISPENSERS



NON-LOCKING TOILET TISSUE DISPENSER by SAN JAMAR®

No. 150-5027

- Spring tension controls delivery
- No spindle for easy roll replacement
- Bright chrome finish



HEAVY-DUTY TOILET TISSUE DISPENSERS

- Spring tension controls delivery
- Chrome-plated, zinc die-cast

No. 141-1077 Single roll

No. 141-1082 Double roll



HEAVY-DUTY CONTROLLED DELIVERY TOILET TISSUE DISPENSER by BOBRICK

No. 141-1058

- Double roll
- Minimizes paper waste by allowing roll to turn only a half revolution per pull
- Spindles have a hidden locking device to prevent theft
- Roll cannot be removed until empty
- Heavy aluminum casting

No. 141-1142 Replacement roller

No. 141-2014 Key



SELF-LOCKING TOILET TISSUE DISPENSER

No. 141-1083

- Double roll
- Self-locking device prevents removal until roll is empty
- Chrome-plated steel



CONTROLLED DELIVERY TOILET TISSUE DISPENSERS

No. 141-1084

- Minimizes paper waste by allowing roll to turn only a half revolution per pull
- Roll cannot be removed until empty
- Double roll
- Die-cast aluminum with silver enamel finish

No. 141-1085 Replacement roller only

REPLACEMENT ROLLERS



VANDAL RESISTANT REPLACEMENT ROLLER

No. 141-1059

- Used on Bobrick tissue dispensers
- Vandal resistant
- Includes spindle key
- Black



REPLACEMENT ROLLER

No. 141-1086

- Used on Bobrick tissue dispensers
- Black



LOCKING TOILET TISSUE DISPENSER by SAN JAMAR®

No. 150-5018

- Anti-theft lock prevents tissue roll theft
- Spring tension controls delivery
- Bright chrome finish



TISSUE DISPENSER by BOBRICK

No. 141-2098

- Recess mounted
- 5¼" H x 11¾" W x 3¾" D (135mm x 300mm x 85mm) wall opening
- Holds rolls up to 5½" (130mm) diameter
- Chrome-plated plastic spindles
- Stainless steel construction

TOILET TISSUE DISPENSERS



TOILET TISSUE DISPENSER by BOBRICK

No. 141-2015

- Holds two 10" (254mm) jumbo rolls
- Sliding panel covers second roll until first roll is empty
- Tamper resistant with key
- 11½" H x 20¾" W x 5¼" D (292mm x 527mm x 133mm)
- Stainless steel exterior, plastic interior

No. 141-1161 Key



TISSUE DISPENSER by SAN JAMAR®

No. 150-5030

- Holds 2 standard or industrial size rolls up to 5½" (140mm) diameter
- Tamper resistant with key
- 8¼" H x 12½" W x 6" D (210mm x 318mm x 152mm)
- High-impact plastic

No. 150-5033 Key



FREE-FLOWING TOILET TISSUE DISPENSER by SAN JAMAR®

No. 150-5021

- Holds two 9" (229mm) jumbo rolls
- Sliding panel covers second roll until first roll is empty
- Tamper resistant with key
- Uses 3¼" (83mm) core size paper
- 12" H x 19" W x 5¼" D (305mm x 483mm x 133mm)
- High-impact plastic

No. 150-5033 Key



TOILET TISSUE DISPENSER by SAN JAMAR®

No. 150-5024

- Universal for all brands of jumbo bath tissue up to 10½" (267mm) in diameter
- 3¼" (83mm) core diameter
- 13¾" H x 12½" W x 5½" D (349mm x 318mm x 140mm)
- Translucent "Black Pearl" break resistant plastic
- Key and instructions included

No. 150-5033 Key



SATISFACTION GUARANTEED

If you are not completely satisfied with an item for any reason, simply call us within 60 days of the invoice date. We will issue a Return Merchandise Authorization (RMA) number, and you can return the item for credit.

THERE WILL BE NO RESTOCKING CHARGE ON STOCK ITEMS.

In some cases, non-stock items will be subject to a restocking charge or may not be returnable. Custom-made items are not returnable.

SEAT COVER AND TOILET TISSUE DISPENSER by BOBRICK
No. 141-2080

- Holds 500 seat covers and 2 rolls of toilet tissue
- Recess mounted
- 29¼" H x 16" W x 4" D
(745mm x 405mm x 102mm) rough wall opening
- Includes key
- Stainless steel

No. 141-1161 Key for cylinder lock

No. 141-2076 Knob latch (replaces key lock)

SEAT COVER AND TOILET TISSUE DISPENSER; SANITARY NAPKIN DISPOSAL by BOBRICK
No. 141-2082

- Holds 500 seat covers and 2 rolls of tissue
- Recess mounted
- 29¼" H x 16" W x 4" D
(745mm x 405mm x 102mm) rough wall opening
- Includes one key
- Stainless steel

No. 141-1161 Key for cylinder lock

No. 141-2076 Knob latch (replaces key lock)

No. 141-2086 Replacement waste receptacle

DUAL-SIDED SEAT COVER AND TOILET TISSUE DISPENSER; SANITARY NAPKIN DISPOSAL by BOBRICK
No. 141-2081

- Serves 2 toilet compartments
- Each side holds 500 seat covers and 2 rolls of tissue
- One side is flush to allow clearance for a grab bar
- 28⅞" H x 15½" W (735mm x 395mm) rough partition cut-out
- Adjusts to fit ½" to 3⅞" D (13mm to 98mm) partition thickness
- Includes 2 keys
- Stainless steel

No. 141-1161 Key for cylinder lock

No. 141-2076 Knob latch (replaces key lock)

No. 141-2086 Replacement waste receptacle

WASHROOM & MAINTENANCE

SEAT COVER DISPENSER by BOBRICK
No. 141-1091

- Locking hinged door
- Recess mounted
- 11¼" H x 15⅝" W (286mm x 397mm) rough wall opening
- Stainless steel

SEAT COVER DISPENSER by BOBRICK
No. 141-1090

- Surface mounted
- 11" H x 15¾" W x 2" D (279mm x 400mm x 57mm)
- Stainless steel

TOILET SEATS

- Fits most toilets
- Resists cracking
- 5½" (140mm) screw centers
- White

ITEM No.	TYPE	LENGTH	WIDTH
141-1061	Elongated	18⅝" (473mm)	14¼" (362mm)
117-1289	Elongated	18¼" (464mm)	15" (381mm)
141-1062	Round	17" (432mm)	14¼" (362mm)

SANITIZER DISPENSERS by GOJO®

PURELL® HAND SANITIZERS...AMERICA'S #1 BRAND OF INSTANT HAND SANITIZERS

Kills 99.99% of most common germs that may cause illness. Works in as little as 15 seconds. No water or towels are needed. Safe for use by employees with direct food contact. Breakthrough formula eliminates the need to rinse hands after use.



HAND SANITIZER DISPENSER

No. 141-1176

- Wall mounted
- White with gray lever

HAND SANITIZER REFILL

No. 141-1177

- For use with dispenser No. 141-1176
- Food code compliant
- 27 oz (798mL)



HAND SANITIZER DISPENSER

No. 141-2047

- Wall mounted
- NXT® Space Saver™
- Dove gray color



HAND SANITIZER REFILL

No. 141-2048

- For use with dispenser No. 141-2047
- Food code compliant
- 33.8 oz (1000mL)



NEW

TOUCH-FREE HAND SANITIZING FOAM DISPENSER

No. 141-2107

- Model TFX
- Wall mounted
- Includes 3 C batteries and plastic access key

No. 253-1240 Replacement C battery

HAND SANITIZING FOAM REFILL

No. 141-2108

- For use with dispenser No. 141-2107
- 40.5 oz (1198mL)



HAND SANITIZING WIPES

- Effective against 99.9% of common germs
- Contains vitamin A, vitamin E and aloe
- Individually packaged

No. 141-2068 100 wipes

No. 141-2069 1000 wipes



HAND SANITIZER

Make Purell® available anywhere germs are with a portable dispensing system.

No. 141-2049

- Easy-to-use pump dispensing
- Food code compliant
- 2 oz (59mL)

No. 141-2050 Purell belt clip

- Holds No. 141-2049
- 22" retractable cord with O-ring
- Stainless steel belt clip



**A Proud NAFEM
Member For
Over 25 Years.**



SOAP DISPENSERS by GOJO®

MICRELL® ANTIBACTERIAL SOAP...PART OF A COMPLETE HAND HYGIENE REGIME

Specially formulated with a quick-acting antimicrobial agent to kill germs, a light scent, and an effective degreasing agent that makes it perfect for foodservice.



ANTIBACTERIAL FOAM SOAP DISPENSER

No. 141-2051

- Model FMX-12™
- Wall mounted
- Dove gray color



ANTIBACTERIAL FOAM SOAP REFILL

No. 141-2052

- For use with dispenser No. 141-2051
- 42 oz (1250mL)



ANTIBACTERIAL LOTION SOAP DISPENSER

No. 141-2033

- Model NXT® Space Saver™
- Wall mounted
- Dove gray color



ANTIBACTERIAL LOTION SOAP REFILL

No. 141-2036

- For use with dispenser No. 141-2033
- 33.8 oz (1000mL)



TOUCH-FREE MICRELL® ANTIBACTERIAL FOAM SOAP DISPENSER

No. 141-2105

- Model TFX
- Wall mounted
- Includes 3 C cell batteries
- Dove gray color

No. 253-1240 Replacement C battery

ANTIBACTERIAL FOAM SOAP REFILL

No. 141-2106

- For use with dispenser No. 141-2105
- 40.5 oz (1198mL)



FOAM SOAP DISPENSER

No. 141-2053

- Model FMX-12™
- Wall mounted
- Dove gray color



FOAM SOAP REFILL

No. 141-2054

- For use with dispenser No. 141-2053
- 42 oz (1250mL)



LOTION SOAP DISPENSER

No. 141-2056

- Model NXT® Space Saver™
- Wall mounted
- Dove gray color



LOTION SOAP REFILL

No. 141-2057

- For use with dispenser No. 141-2056
- Deluxe with moisturizer and vitamins A and E
- 33.8 oz (1000mL)

SOAP DISPENSERS

AUTOMATIC SOAP DISPENSER by WORLD DRYER

No. 221-1033

- Designed for standard or antibacterial soaps
- Tamper-resistant key locking system
- Includes 2 plastic keys, mounting bracket, and hardware
- Infrared range of 2" to 4" (51mm to 102mm)
- 5½" H x 6" W x 4½" D (120mm x 152mm x 114mm)
- 24 oz (710ml) capacity
- White plastic housing with see-through blue plastic compartment
- Includes 4 AA batteries

No. 253-1241 Replacement AA battery



LIQUID SOAP DISPENSER by BOBRICK

No. 141-1032

- Corrosion resistant valve
- Surface mounted
- 24 oz (710ml) container
- Chrome-plated plastic



LIQUID SOAP DISPENSER

No. 141-1095

- All-metal valve
- Chrome-plated metal bracket
- 16 oz (473ml) plastic globe



LIQUID SOAP DISPENSER

No. 141-1097

- Vertical sights
- Vandal resistant
- 5¾" (146mm) high
- Chrome-plated



LIQUID SOAP DISPENSER by BOBRICK

- Vandal resistant
- Mounts in decks up to 4" (102mm) thick
- Corrosion resistant valve
- Stainless steel spout rotates 360°
- 34 oz (1005ml) plastic bottle

No. 141-1144 4" (102mm) spout

No. 141-2111 6" (152mm) spout

REPLACEMENT PARTS

No. 141-1172 Bottle

- 34 oz (1005ml)

No. 141-2112 Cap



LIQUID SOAP DISPENSERS

- Vandal resistant
- Mounts in decks up to 4½" (114mm) thick
- Shank can be easily cut in the field
- Fits a 1" (25mm) hole
- Chrome valve
- 16 oz (473ml) plastic bottle

No. 141-1024 2½" (64mm) spout

No. 141-1026 4" (102mm) spout

No. 141-1023 Replacement bottle

- 16 oz (473ml)

SOAP DISPENSER by BRADLEY

No. 141-2005

- Mounts in decks up to 4" (102mm) thick
- Fits a 1" (25mm) hole
- 6" (152mm) spout
- Includes adaptor and wrench for easy refilling from the top
- 32 oz (946ml) plastic container

REPLACEMENT PARTS

No. 141-2001 Screw-on adaptor

No. 141-2002 32 oz (946ml) container



SOAP DISPENSERS

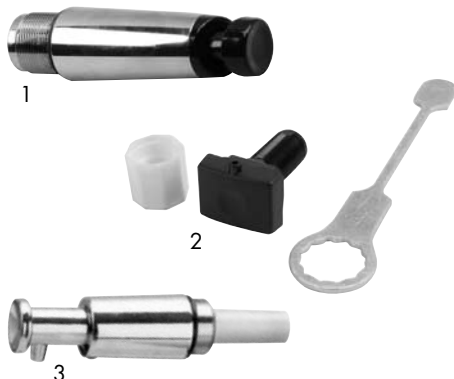

REPLACEMENT SOAP VALVES

- No. 141-1021**
 - Used on Bobrick soap dispenser models B-11, B-12, B-111, B-112, B-201, B-202, B-306, B-310, B-2014, B-2024, B-2111, B-2112, B-3067; also B-310, B-320, and B-330 series consoles
 - Chrome-plated brass body with stainless steel inner spring and spout
- No. 141-1149**
 - For use with standard and antibacterial soaps
 - Used on Bobrick liquid soap dispenser models B4063, B4112, B2111, B2112, B2014
- No. 141-1183**
 - Used on Bradley liquid soap dispenser model nos. 120, 130, 131, 133, 145, 186, 194, 1945, 120-14, 130-14, 131-14, 133-14, 186-14, 194-14, 641, 642, 643, 6437 and 644
 - Stainless steel body with white plastic insert



LIQUID ANTIBACTERIAL SOAP DISPENSER by BOBRICK

No. 141-1148

- For use with standard or antibacterial soaps
- Concealed mounting brackets
- Vandal resistant
- Surface mounted
- 6 1/8" H x 7" W x 3 5/16" D (156mm x 178mm x 84mm)
- 40 oz (1183ml) capacity
- Stainless steel



SOAP DISPENSER by EX-CELL

No. 141-2066

- For use with standard or antibacterial soaps
- Concealed mounting bracket
- Vandal resistant
- Surface mounted
- 5" H x 8 1/4" W x 3" D (127mm x 210mm x 76mm)
- 40 oz (1183ml) capacity
- Stainless steel



TAMPERPROOF SOAP DISPENSER by BOBRICK

No. 141-2097

- For use with standard or antibacterial soaps
- 40 oz (1183ml) capacity
- Surface mounted
- Vandal resistant
- 4 13/16" H x 8 3/16" W x 2 3/4" D (122mm x 208mm x 70mm)
- Stainless steel



LIQUID SOAP DISPENSER by BRADLEY

No. 141-1093

- Locking pull-out tank
- Recess mounted
- 4 1/2" H x 8 1/2" W (114mm x 216mm) rough wall opening
- Stainless steel

PARTS

- No. 141-1169** Cylinder lock
- No. 141-1183** Replacement soap valve
- No. 141-1150** Key for cylinder lock
- Pack of 5



LIQUID SOAP DISPENSER by BOBRICK

No. 141-1140

- Concealed mounting brackets
- Vandal resistant
- Corrosion resistant valve
- Surface mounted
- 6 1/2" H x 5 1/2" W x 3 1/2" D (165mm x 140mm x 89mm)
- 40 oz (1183ml) capacity
- High-impact black plastic



LIQUID SOAP DISPENSER by BOBRICK

No. 141-1168

- Concealed mounting brackets
- Vandal resistant
- 8" H x 6" W x 4" D (203mm x 152mm x 102mm)
- 50 oz (1479ml) capacity
- High-impact gray plastic



SUREFLO® TANK-IN-A-BOX™ LOTION SOAP by BOBRICK

No. 141-2113

- Inner container with a spout for direct dispensing
- 3 gal (12L)
- Pink lotion soap

HAND DRYERS



HAND DRYER by WORLD

No. 221-1025

- Model A
- Surface mounted
- 9 $\frac{3}{8}$ " H x 11 $\frac{3}{8}$ " W x 6 $\frac{5}{8}$ " D
(244mm x 289mm x 168mm)
- 30-second timer
- 115 volt, 20 amp, 2300 watt
- White enamel finish

Note: This dryer requires a 20 amp dedicated breaker.



HAND DRYER by AMERICAN DRYER

No. 181-1028

- Model DR20N
- Surface mounted
- 9 $\frac{1}{4}$ " H x 11" W x 6 $\frac{5}{8}$ " D
(235mm x 279mm x 168mm)
- 110 volt, 20 amp, 2300 watt
- Double-coated white powder epoxy



HAND DRYER by WORLD

No. 221-1026

- Model Airspeed®
- Surface mounted
- 10 $\frac{7}{8}$ " H x 11 $\frac{5}{8}$ " W x 7" D
(276mm x 295mm x 178mm)
- 30-second timer
- 115 volt, 17 amp, 2000 watt
- White enamel finish

"NO TOUCH" HAND DRYERS



"NO TOUCH" HAND DRYER by AMERICAN DRYER

No. 181-1030

- Model DR20TN
- Surface mounted
- 9 $\frac{1}{4}$ " H x 11" W x 6 $\frac{5}{8}$ " D
(235mm x 279mm x 168mm)
- "No touch" feature is sanitary
- Vandal resistant
- 110 volt, 20 amp, 2300 watt
- Double-coated white powder epoxy



ECONOMY "NO TOUCH" HAND DRYER by AMERICAN DRYER

No. 181-1039

- Model GX1
- Surface mounted
- 9 $\frac{3}{8}$ " H x 10 $\frac{1}{8}$ " W x 5 $\frac{5}{8}$ " D
(238mm x 257mm x 143mm)
- "No touch" feature is sanitary
- Vandal resistant
- 110 volt, 12 amp, 1500 watt
- White plastic

"NO TOUCH" HAND DRYERS



COMPACDRYER™ "NO TOUCH" HAND DRYER by BOBRICK

No. 141-1173

- Model B-710
- Surface mounted
- 10¼" H x 10½" W x 5½" D
(260mm x 267mm x 143mm)
- "No touch" feature is sanitary
- Vandal resistant
- 115 volt, 15 amp, 1725 watt
- Fire retardant, gray, plastic cover



BLUStORM™ "NO TOUCH" HAND DRYER by PALMER FIXTURE

No. 141-2100

- Model HD950SS
- Surface mounted
- 11" H x 9" W x 7" D (279mm x 229mm x 178mm)
- "No touch" feature is sanitary
- Vandal resistant
- Dries hands in less than 10 to 15 seconds
- Automatic power cut-off in case of irregular use over 60 seconds
- 120 volt, 900 watt
- Stainless steel with black plastic



EXTREMEAIR® "NO TOUCH" HAND DRYER by AMERICAN DRYER

Dries hands completely in 10 to 15 seconds, and uses up to 80% less energy than conventional hand dryers.

No. 181-1040

- Model GXT6M
- Surface mounted
- 9¾" H x 10½" W x 5½" D
(238mm x 257mm x 143mm)
- "No touch" feature is sanitary
- Vandal resistant
- 120 volt, 12.5 amp, 1500 watt
- White powder epoxy



XLERATOR® "NO TOUCH" HAND DRYER by EXCEL

Heavy-duty, automatic hand dryer is sanitary and vandal resistant. It is activated by an infrared optical sensor, and its powerful heating element dries hands within 15 seconds.

No. 268-1036

- Model XL-W
- Surface mounted
- 12½" H x 11¾" W x 6½" D
(322mm x 298mm x 170mm)
- 120 volt, 12.5 amp, 900 watt
- Includes security key and installation/maintenance instructions
- White powder epoxy



"NO TOUCH" HAND DRYER

No. 141-2101

- Model HD903WH
- Surface mounted
- 8¾" H x 10½" W x 6¾" D
(222mm x 267mm x 171mm)
- "No touch" feature is sanitary
- Vandal resistant
- Dries hands in 30 seconds
- Automatic power cut-off in case of irregular use over 120 seconds
- Automatically shuts off when hands are pulled away
- 120 volt, 1800 watt
- White plastic

PAPER TOWEL DISPENSERS by SAN JAMAR®

NEW



TEAR-N-DRY ECO AUTOMATIC TOWEL DISPENSER

Eco-friendly! Smaller profile means 15% less materials used, and fits in more places.

No. 150-6058

- For 8" (203mm) wide paper rolls
- Preset to deliver 10" (254mm) length of towel
- 14½" H x 11¾" W x 9⅞" D (368mm x 298mm x 232mm)
- Includes key
- Uses 4 D cell batteries (not included)
- Translucent "Black Pearl" break resistant plastic

No. 150-5033 Replacement key

No. 253-1239 D cell battery



TOWEL DISPENSER

No. 150-4508

- For 8" (203mm) wide paper rolls
- Infinity system allows for uninterrupted availability of paper while eliminating roll waste
- Surface mounted
- Handle treated with Bio-Pruf® to inhibit bacteria growth
- 15½" H x 12½" W x 9" D (394mm x 318mm x 229mm)
- Translucent "Black Pearl" break resistant plastic
- Includes key and instructions

No. 150-5033 Replacement key



TOWEL DISPENSER

No. 150-6019

- For 8" (203mm) wide paper rolls, including coreless paper rolls
- Surface mounted
- Integrated lever minimizes needed space and makes dispensing easy
- 13½" H x 11½" W x 11¼" D (343mm x 292mm x 286mm)
- Translucent "Black Pearl" break resistant plastic
- Includes key and instructions

No. 150-5033 Replacement key



SMART SYSTEM WITH IQ SENSOR AUTOMATIC TOWEL DISPENSER

Touchless, battery-powered towel dispenser allows only a small piece of paper to exit before dispensing the desired length—small, medium, or large. It can dispense all paper qualities and is ideal for high traffic washrooms. Just tear and dry. Dispenser also includes free, downloadable software to help manage stock and maintenance.

No. 150-4541

- For 8" (203mm) wide paper rolls
- Simple paper length and delay preset buttons for portion control
- 15½" H x 11¼" W x 9" D (394mm x 285mm x 229mm)
- Translucent "Black Pearl" break resistant plastic
- Includes key
- Uses 4 D cell batteries (not included)

No. 150-5033 Key

No. 253-1239 D battery



TEAR-N-DRY AUTOMATIC TOWEL DISPENSER

Perfect for a touchless bathroom.

No. 150-6026

- For 8" (203mm) wide paper rolls
- Preset to deliver 10" (254mm) length of towel
- 15½" H x 11" W x 9" D (394mm x 279mm x 229mm)
- Includes key
- Uses 4 D cell batteries (not included)
- Translucent "Black Pearl" break resistant plastic

No. 150-5033 Replacement key

No. 150-6053 Replacement cover

No. 253-1239 D battery

PAPER TOWEL DISPENSERS by SAN JAMAR®



TOWEL DISPENSER

Ideal for employee use applications.

No. 150-4535

- Handles standard 8" (203mm) wide rolls
- Surface mounted
- Not portion controlled
- 9½" H x 12" W x 10½" D (248mm x 305mm x 267mm)
- White
- High-impact plastic



TOWEL DISPENSER

No. 150-4526

- Handles rolls up to 9" (229mm) wide
- Crank action towel dispenser
- Surface mounted
- 10¾" H x 10¾" W x 8½" D (273mm x 273mm x 216mm)
- All metal, white enamel finish

No. 150-4532 Key for cylinder lock

PAPER TOWEL TYPES

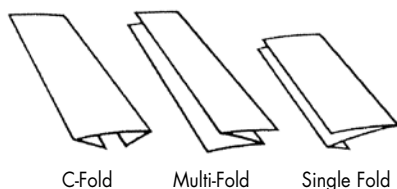

C-Fold

Multi-Fold

Single Fold



TOWEL DISPENSER

No. 150-4529

- Handles virtually all 8" (203mm) wide rolls
- Lever action towel dispenser
- Surface mounted
- 15¾" H x 12½" W x 9" D (400mm x 318mm x 229mm)
- Includes key
- High-impact plastic

No. 150-5033 Replacement key



TOWEL DISPENSER

No. 150-4520

- For C-fold or multi-fold paper towels
- Ideal for health care facilities
- Space-saving design
- Surface mounted
- 7¾" H x 11¾" W x 3⅞" D (197mm x 289mm x 98mm)
- Constructed of 20 gauge steel
- Matte chrome finish

No. 150-4532 Key for cylinder lock



MINI ULTRAFOLD™ TOWEL DISPENSER

No. 150-6034

- Ideal for small spaces
- For C-fold or multi-fold paper towels
- Can be mounted on mirrors using adhesive strips (included) or surface mounted using screws (not included)
- 11½" H x 11½" W x 6" D (292mm x 292mm x 152mm)
- Includes key
- "Black Pearl" break resistant plastic

No. 150-5033 Replacement key



TOWEL DISPENSER

No. 150-4511

- For C-fold or multi-fold paper towels
- Viewing slots for easy towel level monitoring
- Surface mounted
- 15" H x 11¾" W x 3⅞" D (381mm x 289mm x 98mm)
- Constructed of 20 gauge steel
- Matte chrome finish

No. 150-4532 Key for cylinder lock

PAPER TOWEL DISPENSERS

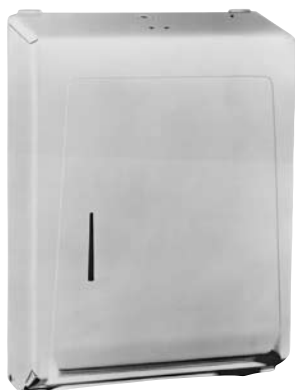

TOWEL DISPENSER

No. 141-1054

- For multi-fold or C-fold paper towels
- Surface mounted
- 15" H x 11" W x 4" D (381mm x 279mm x 102mm)
- Includes key
- White enamel

No. 150-4532 Key for cylinder lock



TOWEL DISPENSER by EX-CELL

No. 141-2067

- For multi-fold or C-fold paper towels
- Surface mounted
- 14 3/4" H x 11 1/4" W x 4" D (375mm x 286mm x 102mm)
- Includes 2 keys
- Stainless steel



TOWEL DISPENSER

No. 141-1185

- For multi-fold and C-fold paper towels
- Transparent dark blue front for easy content level monitoring
- Surface mounted
- 15 1/4" H x 11 1/4" W x 5" D (387mm x 286mm x 127mm)
- Includes key
- 20 gauge steel back and transparent, impact resistant, plastic front

No. 150-4532 Key for cylinder lock



TOWEL DISPENSER

No. 141-1056

- For single fold towels
- Surface mounted
- 7 1/2" H x 12 1/4" W x 6 1/2" D (191mm x 311mm x 165mm)
- Includes 2 keys
- White enamel

No. 150-4532 Key for cylinder lock



TOWEL DISPENSER by SAN JAMAR®

No. 150-4523

- Easy-to-mount, perforated towel dispenser
- Surface mounted
- 3" H x 13 1/4" W x 4 3/4" D (76mm x 337mm x 121mm)
- Constructed of 24 gauge steel
- Matte chrome finish

PAPER TOWEL TYPES

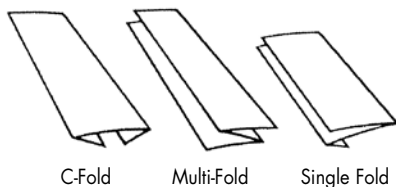

C-Fold

Multi-Fold

Single Fold

REPLACEMENT KEYS



1



2



3



4

DISPENSER KEYS

- No. 141-1150*** Bradley key
 - For all Bradley towel, soap, tissue, and napkin dispensers
 - Pack of 5
- No. 141-1161*** Bobrick key
 - For cylinder locked Bobrick towel, soap, tissue, napkin dispensers, and waste receptacles
- No. 150-4532** San Jamar key, metal
 - For San Jamar locking paper towel dispensers: Nos. 150-4511, 150-4520, 150-4526
- No. 150-5033** San Jamar key, plastic
 - For San Jamar locking toilet tissue dispensers: Nos. 150-5021, 150-5024, 150-5030
 - For San Jamar towel dispensers: Nos. 150-4508, 150-4529, 150-4541, 150-6019, 150-6026, 150-6034

* These keys do not fit the coin locks on the dispensers.

PAPER TOWEL DISPENSERS by BOBRICK



TOWEL DISPENSER

No. 141-2078

- For multi-fold or C-fold paper towels
- Recess mounted
- 15 $\frac{5}{8}$ " H x 11 $\frac{1}{4}$ " W x 4" D
(397mm x 286mm x 102mm) rough wall opening
- Includes key
- Stainless steel

No. 141-1161 Key for cylinder lock

No. 141-2075 Knob latch (replaces key lock)



TOWEL DISPENSER

No. 141-2079

- For multi-fold or C-fold paper towels
- Surface mounted
- 14" H x 10 $\frac{3}{4}$ " W x 4" D (356mm x 273mm x 102mm)
- Includes knob latch
- Stainless steel

No. 141-2075 Knob latch



TOWEL DISPENSER

No. 141-1163

- For multi-fold or C-fold paper towels
- Surface mounted
- Quick refill access and hidden locking device
- 15 $\frac{1}{4}$ " H x 11 $\frac{1}{2}$ " W x 4 $\frac{7}{8}$ " D
(387mm x 292mm x 124mm)
- Includes key
- High impact plastic

No. 141-1161 Key for cylinder lock



TOWEL DISPENSER

No. 141-1053

- For multi-fold or C-fold paper towels
- Surface mounted
- 14" H x 10 $\frac{3}{4}$ " W x 3 $\frac{7}{8}$ " D (356mm x 273mm x 98mm)
- Includes key
- Stainless steel

No. 141-1161 Key for cylinder lock

WASTE RECEPTACLE



WASTE RECEPTACLE by BOBRICK



No. 141-2110

- Recess mounted
- 29 $\frac{1}{4}$ " H x 16" W x 4" D
(745mm x 405mm x 102mm) rough wall opening
- Removable 12 gal (45l) receptacle locks into a cabinet
- Stainless steel

PARTS

No. 141-2109 Cylinder lock with key

No. 141-2070 Replacement waste receptacle

PAPER TOWEL DISPENSERS WITH WASTE RECEPTACLE



PAPER TOWEL DISPENSER WITH WASTE RECEPTACLE by BOBRICK

No. 141-1051



- Projecting waste receptacle
- For C-fold or multi-fold towels
- Recess mounted
- 54½" H x 15⅝" W x 4" D (1384mm x 397mm x 102mm) rough wall opening
- Stainless steel

PARTS

- No. 141-2070 Replacement waste receptacle
 No. 141-2092 Towel dispenser lock with key
 No. 141-2109 Waste receptacle lock with key
 No. 141-1161 Key for cylinder lock
 No. 141-2073 Top door knob latch
 No. 141-2074 Waste bin knob latch

Note: Latch is used in place of key lock.

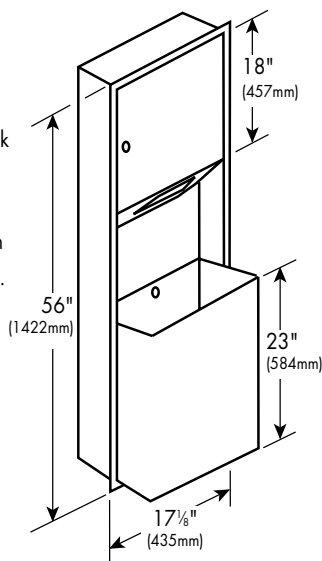

PAPER TOWEL DISPENSER WITH WASTE RECEPTACLE by BRADLEY

No. 141-1052



- Unit has removable waste receptacle behind a locking hinged door
- For C-fold or multi-fold towels
- Recess mounted
- 54½" H x 15⅝" W x 4" D (1384mm x 397mm x 102mm) rough wall opening
- Stainless steel

PARTS

- No. 141-1169 Cylinder lock for waste receptacle
 No. 141-1150 Key for cylinder lock
 • Pack of 5

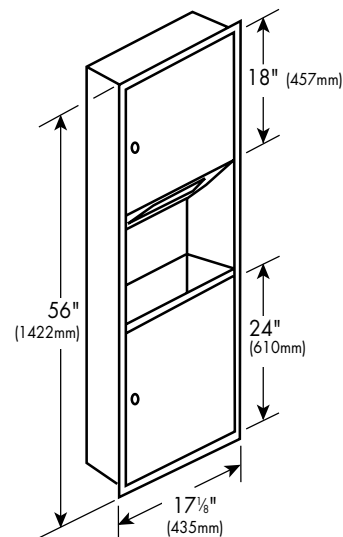

PAPER TOWEL DISPENSER WITH WASTE RECEPTACLE by BOBRICK

No. 141-2099

- Recess mounted
- Accepts standard 8" x 8" (203mm x 203mm) rolls
- Includes waste receptacle
- 54¾" H x 16" W x 4" D (1390mm x 405mm x 102mm) rough wall opening
- Stainless steel

PARTS

- No. 141-1161 Key for cylinder lock
 No. 141-2070 Waste receptacle
 No. 141-2109 Waste receptacle lock with key

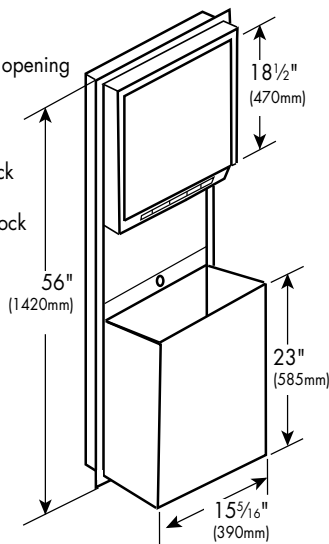

PAPER TOWEL TYPES

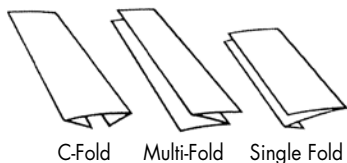

TAMPON & SANITARY NAPKIN UNITS



1



2

TAMPON AND SANITARY NAPKIN DISPENSERS by BOBRICK

- \$.25 coin box
- Includes 2 keys
- Stainless steel

1. **No. 141-1195** Recess mounted
 - 25¹/₁₆" H x 14³/₁₆" W x 3¹/₁₆" D (637mm x 371mm x 100mm) rough wall opening
2. **No. 141-2000** Surface mounted
 - 25⁷/₈" H x 11⁷/₈" W x 6¹/₂" D (657mm x 302mm x 165mm)

PARTS FOR No. 141-2000

- No. 141-1191** Coin box key
- No. 141-1192** Rotor
- No. 141-1194** Coin mechanism (receives dimes only)
- No. 141-1196** Handle with screw
- No. 141-1198** Lock with key
- No. 141-2010*** Coin box cover with lock and key

*Also for No. 141-1195

HEAVY-DUTY TAMPON AND SANITARY NAPKIN DISPENSER by BRADLEY

Coin mechanism can be changed easily without tools. Coin boxes are protected by double door locks. Dispenser will automatically refuse coins after last product is sold.

No. 141-1017

- \$.25 coin box
- Holds 30 napkins and 27 tampons
- Surface mounted
- 25⁷/₈" H x 11⁷/₈" W x 6¹/₂" D (657mm x 302mm x 165mm)
- Stainless steel

PARTS

- No. 141-1169** Cylinder lock
- No. 141-1150** Key for cylinder lock
- Pack of 5



TAMPON AND SANITARY NAPKIN DISPOSAL UNIT by BOBRICK

No. 141-1199

- Surface mounted
- 11" H x 8" W x 4" D (279mm x 203mm x 102mm)
- Stainless steel

TAMPON AND SANITARY NAPKIN DISPOSAL UNIT by BOBRICK

No. 141-1197

- Self-closing push door
- Includes removable plastic receptacle
- Partition mounted (serves 2 compartments)
- 17³/₈" H x 12³/₄" W x 4¹/₈" D (437mm x 324mm x 103mm)
- Stainless steel

PARTS

- No. 141-1187** Replacement receptacle



TAMPON AND SANITARY NAPKIN DISPOSAL UNIT by BOBRICK

No. 141-1076

- Self-closing push door
- Removable plastic receptacle
- Surface mounted
- 15¹/₈" H x 10³/₄" W x 4" D (384mm x 273mm x 102mm)
- Stainless steel

PARTS

- No. 141-1187** Replacement receptacle

CHILD CARE STATIONS



CHILD PROTECTION SEAT by KOALA KARE®

No. 141-1175

- Safer and more sanitary alternative to leaving a child unattended or on the floor
- Can be mounted on any washroom wall or stall door
- Up to 50 lb (23kg) static load
- Microban® protected to inhibit the growth of bacteria
- 19" H x 12" W x 12" D (483mm x 305mm x 305mm) when open (5½" (140mm) deep when closed)
- High-impact plastic
- Koala no. KB102-00

No. 141-2013 Replacement safety strap

- Koala no. 725



SANITARY LINERS by KOALA KARE®

No. 141-1166

- For baby changing stations
- Chemical-free
- 3-ply
- Biodegradable
- Case of 500
- Koala no. KB150-99



WINGIT™ WALL FASTENERS

WingIt Wall Fasteners are the solution for many surface mount installations—from hand dryers and baby changing stations to soap dispensers and grab bars. WingIts install in minutes and ensure a secure, permanent fit that maintains its structural integrity—no matter which direction the loading occurs or how often.

No. 142-1483

- Includes instructions
- Water- and fire-resistant
- 2¼" diameter
- Stainless steel
- Pack of 2

Photographs are used with the permission of Koala Kare® Products.

CHILD CARE STATIONS by KOALA KARE®

BABY CHANGING STATIONS

A safe and sanitary table for changing a baby's diaper.

- Can be mounted onto any washroom wall
- Meets ASTM standards when properly installed
- Weighs only 30 lb (14kg)
- Microban® protected to inhibit the growth of bacteria
- High-impact plastic with steel hinges
- Includes mounting hardware and instructions, and metal door plaque



Horizontal Changing Station
No. 141-1165

HORIZONTAL CHANGING STATION

- 20" H x 35" W x 20" D (508mm x 889mm x 508mm)
when open (4" (102mm) deep when closed)

No. 141-1165 Cream color

- Koala no. KB100-00

No. 141-2102 Gray color

- Koala no. KB100-01

VERTICAL CHANGING STATION

- 36" H x 22" W x 20" D (914mm x 559mm x 508mm)
when open (4" (102mm) deep when closed)

No. 141-1167 Cream color

- Koala no. KB101-00

No. 141-2103 Gray color

- Koala no. KB101-01



Vertical Changing Station
No. 141-1167



OVAL CHANGING STATION

No. 141-2018 Gray color

- 20½" H x 34" W x 20¾" D (521mm x 864mm x 527mm)
when open (4" (102mm) deep when closed)
- Koala no. KB108-01

REPLACEMENT PARTS

No. 141-1184 Safety strap for use on horizontal changing station

- Koala no. 885

No. 141-2012 Safety strap for use on vertical changing station

- Koala no. 889

No. 141-2037 Koala Kare decal for use on horizontal and vertical changing stations

- Koala no. 825

No. 141-2039 Spring mechanism for use on vertical changing stations

- Koala no. 877

No. 141-2071 Spring mechanism for use on horizontal changing stations

- Koala no. 874



Oval Changing Station
No. 141-2018

Photographs are used with the permission of Koala Kare® Products.

BATHROOM PARTITIONS by BOBRICK

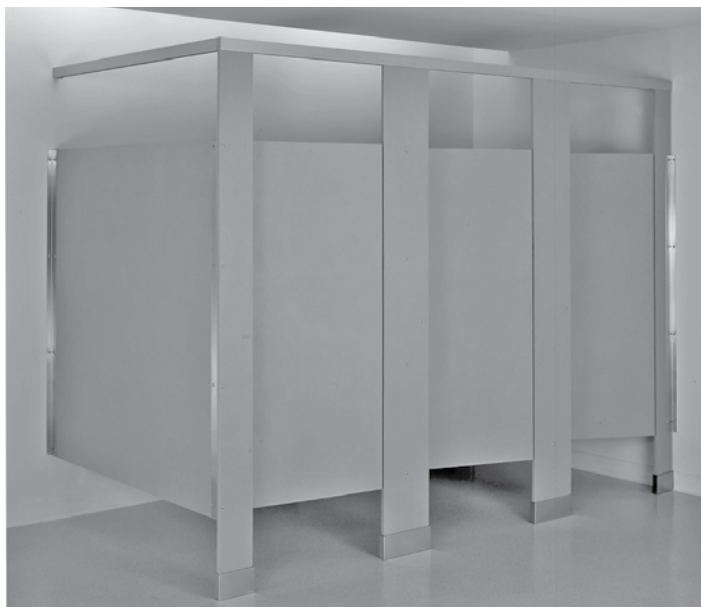

Overhead-braced Mounting Configuration Shown

1090 SIERRA SERIES® TOILET PARTITION SYSTEM

Vandal and Graffiti Resistant. An Environmentally Responsible Product.

Made of Solid Color Reinforced Composite (SCRC) dyed wood fibrous material, these partitions are scratch, dent, moisture, and impact resistant. They can hold up to the heaviest restroom traffic and even have non-ghosting graffiti removal. Available in 4 earthtone colors—Golden Khaki, Desert Beige, Terra Cotta, and Forest Green.

No. 300-1115

- 3/4" (19mm) thick door stiles
- 1/2" (13mm) thick panels
- Stile base leveling device included
- Reinforced with polycarbonate and phenolic resins
- Class B ASTM E84 Interior Wall and Ceiling Finish Classification
- LEED Program contribution
- Solid color, clear through
- 10 year limited warranty against corrosion, warpage, breakage, and delamination

SAMPLE:

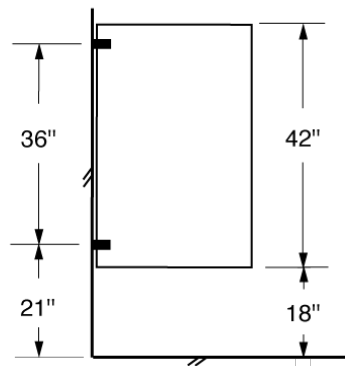
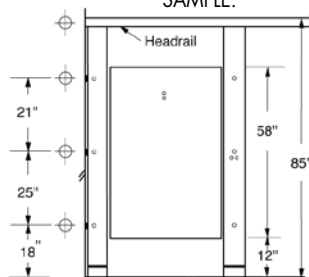

URINAL PARTITIONS

- 1/2" (13mm) thick panels
- 10 year limited warranty against corrosion, warpage, breakage, and delamination

No. 300-1116 42" H x 18" W (1067mm x 457mm)

No. 300-1117 42" H x 24" W (1067mm x 610mm)



STANDARD CONCEALED HARDWARE

Contains 3 robust barrel hinges that adjust for partial opening or self-closing, a reinforced latch with a through-bolted keeper, a through-bolted clothing hook, and vandal resistant doorstops.

- Heavy gauge type 304 satin finish stainless steel
- For emergency access, door lifts from outside

HOW TO ORDER:

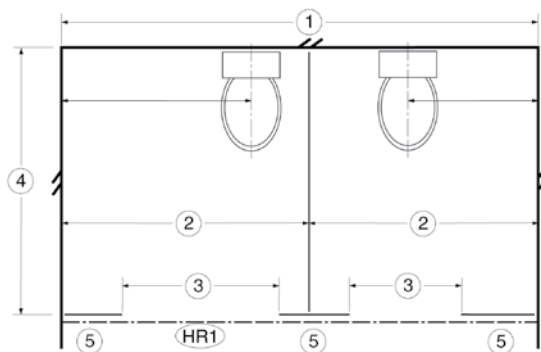

BEFORE YOU BEGIN:

- Sketch the building's wall locations. Note the building walls with double hash marks.
- Mark the approximate toilet locations in the stall. (Note: Toilets should be located 18" (457mm) from either side wall or side divider panel on barrier-free layouts).
- Sketch the existing components (stiles, panels, and doors). Remember to include door swings (left, right, in-swing, and out-swing).
- Select a color.

WHAT TO MEASURE:

- Total overall width of all stalls or the side wall to the end of the last panel.
- Side wall to the centerline of the divider panel (width of each stall).
- Door opening (stile edge to stile edge).
- Compartment depth (back wall to front/outside edge of stile).
- Existing stile width.

HR1—The headrail runs across the front width of the compartments from wall to wall.

Bobrick copyrighted product photographs are used with the permission of Bobrick Washroom Equipment, Inc.

STALL HARDWARE

PARTITION BRACKETS

- Chrome-plated, zinc die-cast



No. 141-1045

- For any thickness
- 1 1/2" x 3 1/2" (38mm x 89mm)



No. 141-1104

- For 1 1/4" (32mm) partitions
- 1 1/4" x 2 1/2" (32mm x 64mm)

No. 141-1189

- For 1" (25mm) partitions
- 1" x 2" (25mm x 51mm)



No. 141-1106

- For 1 1/4" (32mm) partitions
- 1 1/4" x 2 1/2" (32mm x 64mm)



No. 141-1105

- For 1 1/4" (32mm) partitions
- 1 1/4" x 2 1/2" (32mm x 64mm)

No. 141-1188

- For 1" (25mm) partitions
- 1" x 3" (25mm x 76mm)

No. 141-1190

- For 1" (25mm) partitions
- 1" x 2" (25mm x 51mm)



No. 141-1107

- For 1 1/4" (32mm) partitions

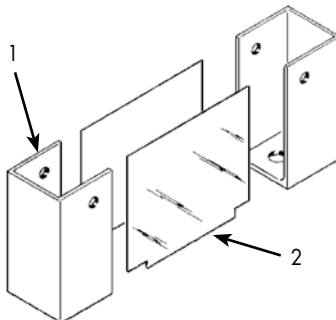

UNIVERSAL PARTITION BASE SHOE

1. **No. 141-1064** End cap
 - For 1 1/4" (32mm) partitions
 - 3" (76mm) high
 - Chrome-plated, zinc die-cast
 - Sold individually—2 required per shoe
2. **No. 141-1065** Spacer plate
 - Easily cut to fit most partitions up to 9" (229mm) wide
 - 3" x 10" (76mm x 254mm)
 - Stainless steel
 - Sold by the pair



PARTITION BASE SHOES

- For 1 1/4" (32mm) thick partitions
- Stainless steel

No. 141-1069 For 3" (76mm) wide partitions

No. 141-1070 For 4" (102mm) wide partitions

No. 141-1071 For 5" (127mm) wide partitions

No. 141-1072 For 6" (152mm) wide partitions

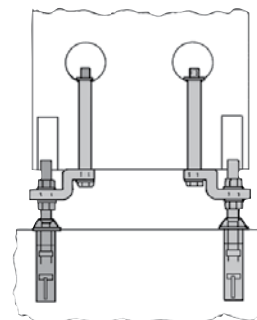

PARTITION ANCHOR KIT

No. 141-1066

- Contains all mounting hardware



HOOK WITH BUMPER

No. 141-1119

- Chrome-plated, zinc die-cast

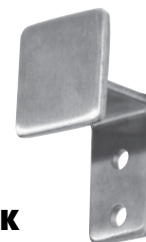

COAT HOOK

No. 141-2011

- For restroom stall doors
- Includes mounting screws



COAT HOOK

No. 141-2104

- Surface mounted
- Includes mounting screws
- Stainless steel

STALL HARDWARE



HANDLE

No. 141-1092

- 2 3/4" or 3" screw centers
- 3 1/8" overall length
- 8-32 thread
- For use with latch (No. 141-1038)
- Chrome-plated, zinc die-cast



HANDLE

No. 134-1050

- 3 1/2" screw centers
- 4 3/4" overall length
- 10-24 thread
- For use with latch (No. 141-1050)
- Chrome-plated, zinc die-cast



HANDLE

No. 132-1090

- 4" screw centers
- 4 3/4" overall length
- 10-24 thread
- Chrome-plated, zinc die-cast



DOOR HINGE SET

No. 141-1158

- For 1 1/4" (32mm) partitions
- Chrome-plated, zinc die-cast



UNIVERSAL HINGE SET

No. 141-1040

- Includes top and bottom hinges
- For 1 1/4" (32mm) partitions with a 1" (25mm) door
- Self-closing
- Chrome-plated, zinc die-cast



SELF-CLOSING UNIVERSAL HINGES

- For use on any material of any thickness
- Includes top and bottom hinges
- Chrome-plated, zinc die-cast

No. 141-1101 For right-hand inswinging or left-hand outswinging doors

No. 141-1102 For left-hand inswinging or right-hand outswinging doors



ONE-WAY FASTENERS

No. 715-1020 10-24 x 1 1/4" machine screw
• For use with barrel nut (No. 717-1000)
• Chrome-plated

No. 717-1000 10-24 barrel nut
• For use with machine screw (No. 715-1020)
• 5/8" long
• Chrome-plated

No. 715-1021 Removal tool



STAINLESS STEEL SHEET METAL SCREWS

- One-way fasteners

No. 716-0812 8 x 3/4"

No. 716-0816 8 x 1"

No. 716-1016 10 x 1"

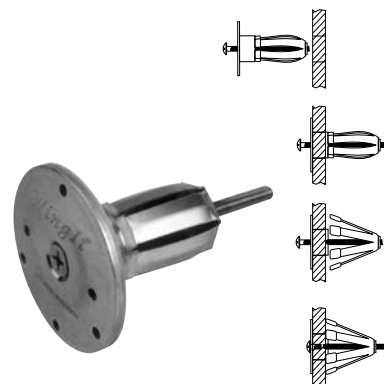

WINGIT™ WALL FASTENER

Specially designed for grab bar mounting.

Installs in minutes, ensuring a secure, permanent fit that maintains its structural integrity.

No. 142-1484

- 2 3/4" (70mm) diameter
- Includes instructions
- Water and fire resistant
- Stainless steel

STALL HARDWARE

CONCEALED LATCH AND STRIKE

- For use inside metal doors
- Fits all 1" (25mm) thick doors
- Chrome-plated, zinc die-cast

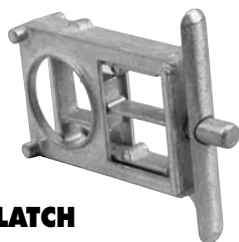

LATCH

No. 141-1099



STRIKE

No. 141-1110

- For 1 1/4" (32mm) partitions



INSIDE/OUTSIDE KNOB SET

No. 141-1047



INSIDE/OUTSIDE KNOB SET

No. 141-1153



THROW LATCH AND STRIKE



ALL-PURPOSE THROW LATCH WITH KEEPER

No. 141-2087

- 5 3/8" (137mm) overall length
- Stainless steel

LATCH

No. 141-1108

- Chrome-plated brass



STRIKE

No. 141-1109

- For 1 1/4" (32mm) partitions
- Chrome-plated, zinc die-cast



SLIDE LATCHES

LATCH

No. 141-1038

- 2 3/4" (70mm) screw centers
- Chrome-plated, zinc die-cast
- Strike not included

Note: One-way fasteners do not fit this latch.



LATCH

No. 141-1050

- 3 1/2" (89mm) screw centers
- Chrome-plated, zinc die-cast
- Strike not included



SLIDE LATCH STRIKES



UNIVERSAL STRIKE

No. 141-1081

- For in-swinging doors
- For any thickness partition
- Chrome-plated, zinc die-cast



STRIKE

No. 141-1039

- For in-swinging doors
- For 1 1/4" (32mm) partitions
- Chrome plated, zinc die cast



STRIKE

No. 141-1041

- For out-swinging doors
- For 1 1/4" (32mm) partitions
- Chrome-plated, zinc die-cast

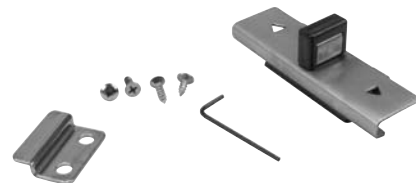

LATCH WITH KEEPER

No. 141-2090

- Surface mounted
- Includes mounting hardware
- Stainless steel



STALL HARDWARE



DOOR HARDWARE SET

No. 141-2007

- Includes stall door hinges, latch assembly (No. 141-2008), latch bumper (No. 141-2091), and mounting screws
- Hinges fit 1 1/4" (32mm) wide partitions



DOOR LATCH BUMPER

No. 141-2009

- Flush mount for a 1 1/4" (32mm) partition
- Includes mounting screws
- Stainless steel



DOOR LATCH ASSEMBLY

No. 141-2008

- 3/4" (19mm) screw centers
- Includes thumb latch, strike, pin, and screws



BUMPER LATCH

No. 141-2091

- Edge mount
- For 1 1/4" (32mm) partitions
- Includes tamperproof mounting screw
- Chrome-plated die-cast



TOWEL BAR

No. 141-1131

- 24" (610mm) long
- Heavy-duty stainless steel bar with chrome-plated metal brackets



GRAB BARS



- 1 1/2" (38mm) wall clearance
- Meets FHA, VA, and HEW requirements
- Sanitary safety grip finish
- Stainless steel

No. 141-1179 24" (610mm) long

No. 141-1180 36" (914mm) long

No. 141-1181 42" (1067mm) long

No. 141-1182 48" (1219mm) long

- 1 1/4" (32mm) diameter tubing

No. 141-1114 24" (610mm) long

No. 141-1115 36" (914mm) long

No. 141-1178 42" (1067mm) long

No. 141-1116 48" (1219mm) long

- 1 1/2" (38mm) diameter tubing



GRAB BARS



- 1 1/2" (38mm) wall clearance
- 1 1/2" (38mm) diameter tubing
- Meets FHA, VA, and HEW requirements
- Stainless steel

No. 141-2093 24" (610mm) long

No. 141-2094 36" (914mm) long

No. 141-2095 42" (1067mm) long



FRAMED MIRROR

No. 141-2096

- 36" x 18" (914mm x 457mm)
- Includes mounting screws
- 1/2" (13mm) stainless steel frame
- Glass mirror

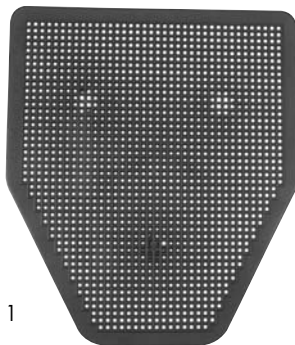

1

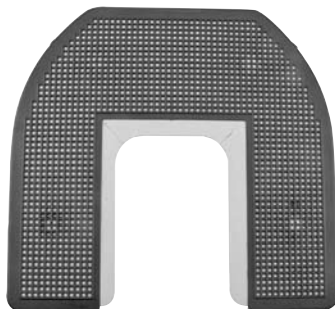

2

DISPOSABLE FLOOR MATS

- 50 oz (1479ml) absorbent pad
- Long-lasting: 30 day average rate of use
- Non-skid backing
- Case of 6

1. **No. 141-2088** For urinals
2. **No. 141-2089** For toilets

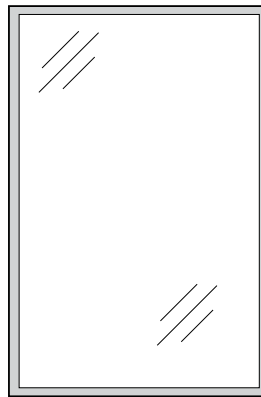

VANDAL PROOF MIRROR

The mirror, protected by a clear plexi-shield, resists graffiti, minimizes vandalism, and eliminates the danger of shattered glass.

No. 141-2062

- 24" x 36" (610mm x 914mm)
- Includes mounting and dismantling tools, and tamperproof screws
- Stainless steel front bezel

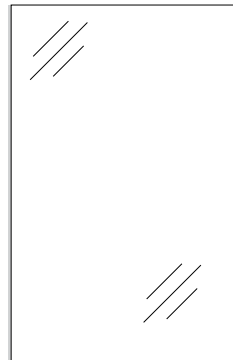

REPLACEMENT MIRROR SHIELD

No. 141-2063

- 20" x 30" (508mm x 762mm)
- Clear Plexiglas®
- Pack of 5

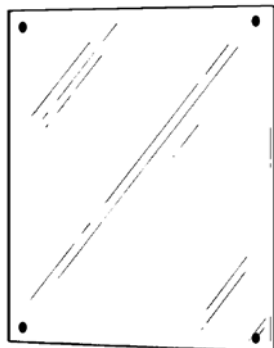

UNBREAKABLE MIRRORS

- 18" x 24" (457mm x 610mm)
- Highly polished stainless steel

- No. 141-1111** Bradley
No. 141-1174 Bobrick



URINAL FILTER CARTRIDGE

No. 141-2084

- For use on Falcon™ or Sloan® waterless urinals
- Kit includes 2 filters, 2 filter removal tools, 2 pairs of gloves, and 2 plastic bags
- Sold by the pair



TOILET DEODORIZER

No. 141-1125

- Clips onto toilet rim
- Green apple fragrance lasts up to 30 days
- Plastic



URINAL SCREEN WITH DEODORANT

- Disposable
- 6 1/16" x 6 1/16" x 1 3/8" H (170mm x 170mm x 35mm)
- Plastic

No. 141-1048 Cherry fragrance

No. 141-1152 Green apple fragrance

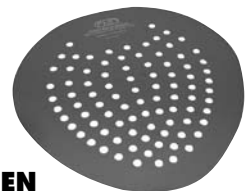

SCENTED URINAL SCREEN

- Disposable, furnished with glove for removal
- 7" x 8" (178mm x 203mm)
- Plastic

No. 141-1126 Mint fragrance

No. 141-1151 Bubble gum fragrance



URINAL SCREEN

- Disposable
- Removal tool included
- Plastic

No. 141-1042 10 3/4" x 11 3/8" (273mm x 289mm)

No. 141-1043 12 3/4" x 12 1/4" (324mm x 311mm)

ERGO TOILET BOWL BRUSH SYSTEM by UNGER®

Cleans more effectively in less time.
Reduces risk of cross-contamination.
Designed for increased comfort and less chance of injury.

No. 142-1521

- 26" (660mm) long handle
- Includes 2 nylon brush heads
- 16½" (420mm) holder with removable base



TOILET BOWL BRUSH

No. 159-1120

- 15¾" (391mm) long
- Includes hanging hook
- Yellow nylon bristles



TOILET BRUSH

No. 159-1066

- 1" (25mm) long yellow and white nylon bristles
- 11¼" (268mm) white plastic handle



ANGLED HEAD TOILET BOWL BRUSH

No. 142-1432

- Soft, acid resistant, acrylic, angled cleaning end
- 13" (330mm) white plastic handle



TOILET BOWL BRUSH

No. 142-1390

- 20" (508mm) with stiff, black plastic bristles
- 4¾" x 5" (121mm x 127mm) brush area
- White plastic handle



PLUNGER

No. 280-1246

- For use on toilets and sinks
- Black 6" (152mm) wide rubber base on a 21" (533mm) handle



FLOOR DRAIN BRUSH AND HANDLE

1. **No. 142-1456** Handle only
 - Non-absorbent plastic
 - 36" (914mm) long
 - Labeled with "USE FOR FLOOR DRAINS ONLY"
2. **No. 142-1455** Brush only
 - Non-absorbent plastic with tough polypropylene bristles
 - 4" (102mm) diameter

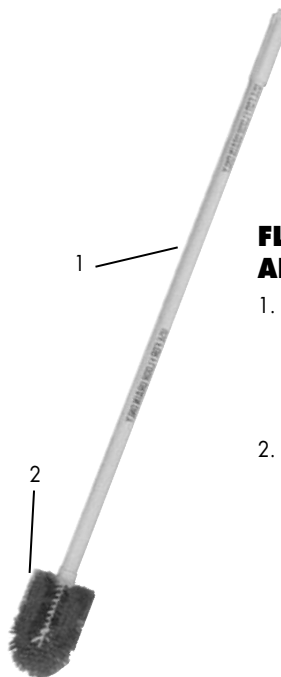

PLUNJ-N-SNAKE™ by DRAIN BLASTER®

Plunger and snake in one tool

Handy tool can be used as a normal plunger to unclog sinks and toilets. Unscrew the T-shaped handle for a Snappy Snake™ which can be inserted into the drain or toilet to clear the clog.

No. 142-1457

- 5¾" (146mm) wide rubber base
- 24" (610mm) snake with "corkscrew" head
- 27" (686mm) clear plastic handle

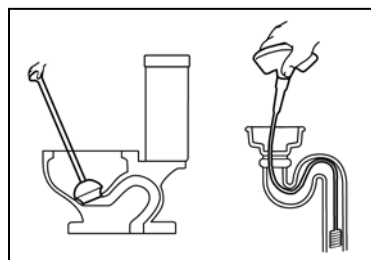



EXHAUST FAN

No. 141-1060

- 115 volt, 70 CFM fan
- 7 $\frac{5}{8}$ " x 7 $\frac{3}{8}$ " (194mm x 187mm) housing with 2 $\frac{7}{8}$ " (73mm) outlet
- 9" x 9 $\frac{1}{4}$ " (229mm x 235mm) grill



DEODORIZING SACHET

No. 159-1053

- For use in refrigerators, freezers, trash bins, basements, and any other area where odors need to be neutralized
- Deodorizes for approximately 30 days
- 50 gram sachet



SEBREEZE® ODOR CONTROL UNIT by RUBBERMAID®

No. 141-1143

- Quiet, battery powered fan moves air across a replaceable fragrance cassette (not included)
- Controls odors in an area up to 4800 cubic feet (136 cubic meters)
- 7 $\frac{3}{4}$ " H x 3 $\frac{5}{8}$ " W x 3 $\frac{1}{2}$ " D (197mm x 92mm x 89mm)
- Wall mounted

SEBREEZE® FRAGRANCE CASSETTES®

- Each cassette lasts approximately 30 days
- Battery included

No. 141-1137 Apple

No. 141-1135 Citrus



COMPACT SEBREEZE® ODOR CONTROL UNIT by RUBBERMAID®

No. 141-1145

- Quiet, battery-powered fan moves air across a replaceable fragrance cassette (not included)
- Ideal for small, confined areas
- 5 $\frac{1}{2}$ " H x 3 $\frac{5}{8}$ " W x 2 $\frac{13}{16}$ " D (140mm x 92mm x 71mm)
- Can be wall mounted or freestanding

SEBREEZE® FRAGRANCE CASSETTES®

- For use with Compact SeBreeze® units
- Each cassette lasts approximately 30 days
- Battery included

No. 141-1146 Lemon/Lime

No. 141-1147 Cinnamon

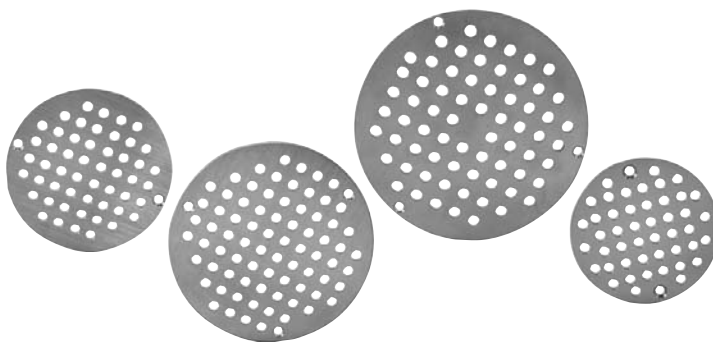

GRATES FOR SMITH FLOOR DRAINS

- Screws included
- Brass

ITEM No.	DRAIN SIZE	OUTSIDE DIAMETER	SCREW CENTERS
102-1080	5" (127mm)	4 $\frac{5}{8}$ " (117mm)	3 $\frac{7}{8}$ " (98mm)
102-1081	6" (152mm)	5 $\frac{1}{2}$ " (140mm)	4 $\frac{15}{16}$ " (125mm)
102-1082	7" (178mm)	6 $\frac{7}{16}$ " (164mm)	5" (127mm)
102-1083	8" (203mm)	7 $\frac{7}{16}$ " (189mm)	6 $\frac{1}{16}$ " (154mm)

No. 102-1106 Replacement screw

FLUSH VALVES



INFRARED FLUSH KIT by SLOAN®

No. 141-2031

- Retrofits toilets and urinals with side mount infrared units
- Hands-free operation
- Includes manual override, low battery warning light, infrared sensor range adjustment screw, reset button, 4 C batteries, and installation tools

No. 253-1240 Replacement C battery



G2 OPTIMA PLUS® INFRARED FLUSH VALVE KITS by SLOAN®



Automatic flush valves save water, are sanitary, and meet ADA requirements. Kits easily convert manual Sloan Flushometers to hands-free automatic operation that require no AC electric hook-up. Efficient 3 year battery life.

- Includes manual override
- 4 AA batteries included
- Low battery warning light

No. 141-1139 Urinal

- Model G2-RESS-U
- Fits urinal flush valve (No. 141-1049)
- Includes 2 flush regulators, 1.0 GPF and 1.5 GPF

No. 141-2026 Toilet

- Model G2-RESS-C
- Fits toilet flush valves (Nos. 141-1044 and 141-1171)
- Includes 2 flush regulators, 1.6 GPF and 3.5 GPF

No. 253-1241 Replacement AA battery

REPLACEMENT PARTS FOR OPTIMA PLUS® TOILET FLUSH VALVE CONVERSION KITS, RESS SERIES



ELECTRONIC MODULE

No. 141-2029

- For model RESS-C-1.6
- Includes 4 AA batteries

No. 253-1241 Replacement AA battery

STOP CAP

No. 141-2027

- For models RESS-C-1.6, RESS-C-3.5, RESS-C-4.5
- For use in 1" H600A/H700A Bak-Chek® Control Stop
- 1 7/8" OD
- Includes sleeve
- Chrome-plated brass



HANDLE CAP

No. 141-2030

- For models RESS-C-1.6, RESS-C-3.5, RESS-C-4.5
- 1 3/4" OD
- Includes gasket
- Chrome-plated brass



DIAPHRAGM KIT

No. 141-2028

- For models RESS-C-1.6, RESS-C-3.5, RESS-C-4.5
- Includes white regulator for 3.5/4.5 GPF

FLUSH VALVES

ROYAL® FLUSHOMETER VALVES by SLOAN®

- Chrome-plated brass
1. **No. 141-1044** Toilet valve, 3.5 GPF
 - Model 110
 - 1" NPS inlet x 1½" OD outlet tube
 1. **No. 141-1171** Toilet valve, 1.6 GPF
 - Model 111
 - For use on low water consumption toilets only
 - 1" NPS inlet x 1½" OD outlet tube
 2. **No. 141-1049** Urinal valve, 1.5 GPF
 - Model 186
 - ¾" NPS inlet x ¾" OD outlet tube



NEW



TOILET FLUSH HANDLES

- Includes threaded plastic nut and brass lever
- Chrome-plated brass

No. 106-1178 Left-hand
No. 106-1179 Right-hand



TOILET FLAPPER

No. 280-1247

- Adjustable to control amount of water per flush

REPLACEMENT PARTS FOR ROYAL® FLUSHOMETER VALVES by SLOAN®



DIAPHRAGM REPAIR KITS FOR FLUSH VALVES

- Contain all necessary internal parts

STANDARD CONSUMPTION

No. 141-1029 Urinal (1.5 GPF)
No. 141-1030 Toilet (4.5 GPF)

LOW CONSUMPTION

No. 141-1160 Urinal (1 GPF)
No. 141-1159 Toilet (1.6 GPF)



REPLACEMENT CAPS FOR FLUSH VALVES

- Chrome-plated brass

No. 141-1013 1½" OD
No. 141-1012 1¾" OD



VACUUM BREAKER REPAIR KIT FOR FLUSH VALVES

No. 141-1031

- Contains all necessary internal parts



HANDLE REPAIR KIT FOR FLUSH VALVES

No. 141-1028

- Contains all necessary internal parts

FAUCETS



DECK MOUNT SLOW CLOSING LAVATORY FAUCET WITH RIGID GOOSENECK SPOUT by T&S BRASS

No. 110-1112

- Eterna series
- 4" centers
- 1/2" NPS x 1 1/2" shanks
- 1/2" inlet adaptor nuts
- Chrome-plated brass
- T&S no. B834



DECK MOUNT SLOW CLOSING LAVATORY FAUCET by T&S BRASS

No. 110-1109

- 4" centers
- 1/2" NPS x 1 1/2" shanks
- 1/2" inlet adaptor nuts
- Chrome-plated brass
- T&S no. B831



AUTOMATIC FAUCET KITS by EQUIP

Hands-free operation virtually eliminates cross-contamination. Indicator light alerts you when there are approximately 8000 cycles or one month of battery life remaining.

- On/Off switch for manual operation
- Red LED low battery indicator
- 60-second maximum running time
- Include 4 AA batteries and AC power adaptor

No. 110-1117 4" deck mount

No. 110-1120 Gooseneck

No. 253-1241 Replacement AA battery



CHEK POINT™ AUTOMATIC FAUCET KIT by T&S BRASS

Hands-free operation virtually eliminates cross-contamination.

No. 110-1116

- Gooseneck spout wall mount
- 120 volt power supply
- Easy retrofit
- Can operate with 4 AA batteries (not included)
- T&S Brass nos. EC1101, EC3101



DECK MOUNT FAUCETS



SINGLE CONTROL FAUCET by ZURN®

No. 117-1290

- 4" centers
- 1/2" NPS x 2" shanks
- Includes inlet adaptor nuts
- 2 GPM aerator
- Polished chrome-plated brass
- Zurn no. Z81000



LAVATORY FAUCET by ZURN®

No. 117-1292

- Lead-free
- 4" centers
- 18" long stainless steel flex hoses
- 3/8" female compression fitting connections
- 2.2 GPM aerator
- Polished chrome-plated brass
- Zurn no. Z7440



LAVATORY FAUCET

No. 107-1045

- 4" centers
- 1/2" NPS x 1 7/8" shanks
- 1/2" inlet adaptor nuts
- Chrome-plated die-cast zinc



LAB SINK FAUCET by T&S BRASS

No. 110-1103

- 4" wrist blades
- 4" centers
- 1/2" NPS x 2 1/4" shank
- 1/2" inlet adaptor nuts
- 5" height from deck to spout tip
- Chrome-plated brass
- T&S no. B892



LAVATORY FAUCET by CHICAGO

No. 114-1006

- 4" centers
- 1/2" NPS x 2 1/4" shanks
- 4" spout
- 2.2 GPM flow rate
- Chrome-plated cast body
- Chicago nos. 802ACP, 802VCP



- No. 114-1007** Reduced flow aerator
- .5 GPM flow rate
 - 1 3/16" thread



LOBBY DUSTPANS

- Dustpan swings into upright position
- Black plastic dustpan

1. **No. 142-1404** 32" H x 12" W
(810mm x 305mm)

- Aluminum handle

2. **No. 159-1087** 35½" H x 12¾" W
(902mm x 324mm)

- Aluminum handle

3. **No. 142-1538** 29½" H x 12" W
(749mm x 305mm)

- Plastic handle

4. **No. 159-1119** 39⅝" H x 11¾" W
(1006mm x 298mm)

- Plastic handle



DUSTPAN

No. 142-1403

- 12" (305mm) wide
- Plastic



ROTOR FLOOR AND CARPET SWEEPER

No. 142-1429

- Telescoping center pivot steel handle
- 44" (1118mm) overall length
- Hangs for storage
- Low-profile, high-impact plastic body

No. 142-1430 Replacement rotor blade

LOBBY BROOMS

- Plastic bristles

5. **No. 142-1405** Additional handle hole for angled sweeping

- 36½" L x 6½" W (927mm x 165mm)
- Metal handle

6. **No. 159-1077** Blue broom stick

- 37¼" L x 6" W (946mm x 152mm)
- Wood handle

6. **No. 159-1076** Black broom stick

- 37¾" L x 6" W (959mm x 152mm)
- Wood handle





FLOOR SCRUBBER

No. 142-1401

- Hardwood block with 2 tapered handle holes
- 12" (305mm) with 2" (51mm) blue plastic bristles
- Handle not included

No. 142-1402 54" (1372mm) long wood handle with tapered end



FLOOR SCRUBBER

No. 142-1399

- For use in open areas or underneath equipment and counters
- 10" (254mm) with 1 1/2" (38mm) yellow plastic bristles
- Tan plastic block
- Handle not included

No. 142-1400 60" (1524mm) long wood handle with threaded nylon tip

No. 142-1433 Shock absorbing adaptor
• Absorbs shock to prevent handle breakage



MULTI-PURPOSE FLOOR BRUSH

No. 159-1071

- 12" (305mm) with 1 1/2" (38mm) blue nylon bristles
- Handle not included

No. 159-1085 54" (1372mm) long blue fiberglass threaded handle



BROOM HEAD

No. 159-1072

- 18" (457mm) with 3" (76mm) red nylon bristles
- For use with threaded handle
- Handle not included



BROOM HEAD

No. 159-1074

- For upright or angled sweeping
- Regular and flagged bristles
- 9" (229mm) with 5" (127mm) long nylon blue bristles
- Handle not included

No. 159-1085 54" (1372mm) long blue fiberglass threaded handle



FLOOR BRUSH

No. 142-1547

- Hardwood block with 2 tapered handle holes
- 10" (254mm) with 2" (51mm) brown palmyra bristles
- Handle not included; accepts threaded and non-threaded handles



DECK BRUSH

No. 159-1107

- 12" L x 5" W (305mm x 127mm)
- 1/16-5 thread
- Black bristles
- White plastic block
- Handle not included



NEW

BROOM HEADS

- 20" L x 13" W (508mm x 330mm)
- 1/16-5 thread
- Corn stalk bristles
- Handle not included

No. 159-1131 Blue stitching

No. 159-1132 Red stitching



NEW

BROOM HEADS

- Angled bristles
- 12 1/4" (311mm) wide
- 1/16-5 thread
- Handle not included

No. 159-1108 Blue

No. 159-1109 Red

No. 159-1110 Green



NEW

INTERCHANGEABLE HANDLES

- 1 5/16" (24mm) OD
- Black PVC swivel end
- 1/16-5 thread
- Aluminum

No. 159-1111 36" (914mm) long, red

No. 159-1112 36" (914mm) long, blue

No. 159-1113 48" (1219mm) long, black

No. 159-1114 53" (1346mm) long, black

WOOD HANDLE

No. 142-1544

- 60" (1524mm) long
- 7/8" (22mm) OD
- Aluminum tip with threaded end

WOOD HANDLE

No. 142-1543

- 60" (1524mm) long with tapered end
- 1 1/8" (29mm) OD

SERVICE SINK FAUCETS



WALL MOUNT SERVICE SINK FAUCET by T&S BRASS

No. 110-1006

- Vacuum breaker spout
- 7" rigid spout with hose thread and pail hook
- 8" centers
- 1/2" NPT female inlets
- Chrome-plated rough brass
- T&S no. B665BSTR



ENCORE WALL MOUNT SERVICE SINK FAUCET WITH SUPPORT BRACKET by CHG

No. 107-1071

- Vacuum breaker spout
- Contains internal check valves
- 6 1/2" spout with hose thread and pail hook
- 8" adjustable centers
- 1/2" NPT female inlets
- Solid brass body with rough chrome finish



VACUUM BREAKER

No. 111-1164

- For use on T&S Brass service sink faucet (No. 110-1006)
- 1/2" NPT

No. 111-1176 Repair kit
• T&S no. B0969RK01



VACUUM BREAKER

No. 111-1015

- 1/2" NPT
- Unfinished brass



ENCORE WALL MOUNT SERVICE SINK FAUCET by CHG

No. 108-1005

- 2 1/2" rigid spout with pail hook and hose thread
- 8" centers
- 1/2" NPT female inlets
- Chrome-plated rough brass

MOP BUCKETS



2-SECTION MOP BUCKET WITH WRINGER by UNGER®

Less Bending. Less Lifting.

Dual bucket keeps dirty water from clean water. High-profile side press is ergonomically designed to reduce bending. Back pour spout makes emptying easy—less bending, increased productivity. Wringer accommodates flat or string mops.

No. 142-1549

- 8 gal (30L) capacity (two 4 gal (15L) compartments)
- 3" (76mm) casters
- Yellow plastic



MOP BUCKETS WITH WRINGER

- 35 qt (33L) capacity
- Black painted steel wringer mechanism and handle
- Includes stop tabs to prevent excess pressure on wringer
- 3" (76mm) swivel casters

No. 159-1095 Blue plastic

No. 159-1146 Yellow plastic



MOP BUCKETS WITH WRINGER by RUBBERMAID®

Heavy-duty, one-piece, molded plastic construction is resistant to most cleaning solutions. Designed with extra room for rinsing a mop head. "Wet Floor" graphic on the sides. High-impact plastic wringer won't bend, chip, or dent. Resists corrosion.

- Side pressure wringer
- 3" (76mm) casters
- WaveBrake® baffles minimize splashing
- Molded hook supports mop handle

No. 262-1123 26 qt (25L) capacity

- Model 7580-88
- Yellow with black graphics

No. 262-1155 35 qt (33L) capacity (not shown)

- Model 7588-88
- Red with yellow graphics

REPLACEMENT PARTS

No. 262-1006 Wringer

- Model 6127
- Yellow

No. 262-1074 Caster

- 3" (76mm)



MOP BUCKETS WITH WRINGER

- 26 qt (25L) capacity
- 19½" (493mm) high
- Includes four 3" (76mm) swivel casters and universal caution sign

No. 159-1099 Blue plastic with yellow wringer

No. 159-1100 Red plastic with green wringer

REPLACEMENT PARTS

No. 159-1101 Blue plastic bucket

No. 159-1102 Red plastic bucket

No. 159-1103 Yellow wringer

No. 159-1104 Green wringer



MOP HEADS

- 23 oz (680ml)
- 8½" (216mm) wide

No. 159-1105 Blue cloth

No. 159-1106 Red cloth



THREADED MOP HEAD

No. 159-1067

- For rough surfaces
- 4" x 5" (102mm x 127mm) abrasive pad attached
- Cotton/polyester

No. 159-1085 54" (1372mm) long blue fiberglass threaded handle



LOOP END MOP HEAD

No. 159-1017

- 5" (127mm) wide headband
- 16–20 oz (473–591ml)
- 4-ply 50% cotton/50% rayon blend



MOP HEAD

No. 142-1568

- 5⅝" (143mm) wide headband
- 11 oz (325ml)
- Gray microfiber with red stripe

THREADED FIBERGLASS HANDLE

No. 159-1085

- 54" (1372mm) long
- Blue fiberglass threaded handle



QUICK RELEASE MOP HANDLE

No. 159-1023

- Used with loop end mop head (No. 159-1017)
- 60" (1524mm) overall length
- 54" L x 1" diameter (1371mm x 25mm) fiberglass handle
- Includes teeth for gripping



LOOP END MOP HOLDER

No. 159-1021

- Used with loop end mop (No. 159-1017)
- 62" (1575mm) overall length
- 55" long x 1⅝" thick (1397mm x 29mm) wood handle
- 7¼" (184mm) wide zinc-plated steel holder



BUCKET FILL HOSE by UNGER®

No. 142-1554

- 72" (1829mm) long
- Clear vinyl tubing with rubber spout adaptor

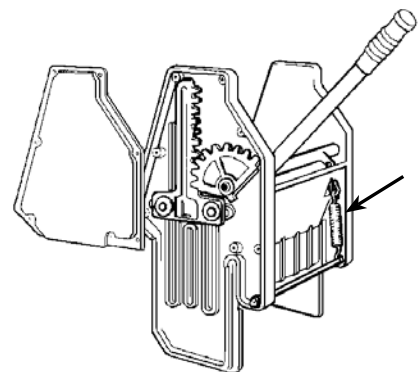

REPLACEMENT SPRING FOR RUBBERMAID MOP WRINGERS

No. 262-1085

- For models 6122, 6123



CASTERS FOR RUBBERMAID MOP BUCKETS

No. 262-1073 2" (51mm) caster with insert

No. 262-1074 3" (76mm) caster with insert



KLEEN-PAIL® SOLUTION BUCKETS by SAN JAMAR®

- Dedicated use containers
- Plastic

SANITIZING SOLUTION BUCKETS

- Red

1. **No. 150-6011** 3 qt (3L)
1. **No. 280-1284** 6 qt (6L)
1. **No. 150-6013** 8 qt (8L)
2. **No. 150-6016** 10 qt (9L)

SOAP SOLUTION BUCKETS

- Green

1. **No. 150-6012** 3 qt (3L)
1. **No. 150-6000** 6 qt (6L)
1. **No. 150-6014** 8 qt (8L)
2. **No. 150-6017** 10 qt (9L)

WRITABLE LABEL AREA BUCKETS

3. **No. 150-6035** 6 qt (6L) (not shown)
 - Blue
3. **No. 150-6036** 6 qt (6L)
 - Yellow

KLEEN-PAIL® CADDY™ by SAN JAMAR®

4. **No. 150-6018**

- Reduces food safety risks by using one tool for cleaning and sanitizing
- 4 qt (4L)
- Includes spray bottle
- Green plastic



QUATERNARY SANITIZING TABLETS

No. 142-1572

- For sanitizing non-porous food contact surfaces
- One tablet makes one gallon (4L) of solution
- 150 tablets



THE ABSORBER® TOWEL

Soaks up liquid faster than a conventional towel, sponge, or chamois.

The Absorber® will last for years with proper care and is resistant to chemicals, detergents, and ammonia. Storage container is included.

No. 280-1331

- 13" x 17" (330mm x 432mm)



CADDY

No. 159-1064

- For transporting spray bottles, brushes, etc.
- 4 compartments
- 17½" L x 10¼" W x 6¼" H (448mm x 260mm x 159mm)
- Yellow plastic



CADDY

No. 159-1121

- For transporting cleaning supplies, such as spray bottles and brushes
- 3 compartments
- 15⅞" L x 9¾" W x 4⅝" H (403mm x 248mm x 117mm)
- Yellow plastic



SPRAY BOTTLES

- Adjustable spray from stream to mist
- Plastic

No. 142-1290 16 oz (473mL)

No. 142-1420 24 oz (710mL)



SPRAY BOTTLE RACK

No. 159-1091

- For spray bottles
- 18" (457mm) long
- Includes mounting hardware
- Chrome-plated steel
- Pack of 2

CLEANING TOOL HOLDER

No. 150-6010

- Set of 2
- Includes mounting hardware



CLEANING TOOL HOLDERS

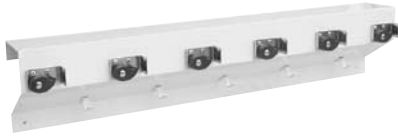

CLEANING TOOL ORGANIZER WITH SHELF

No. 159-1030

- For mops, brooms, and other cleaning tools with handles
- 34" (864mm) wall mount unit
- 6 metal hooks with spring action grippers
- 4" (102mm) top shelf
- Includes color-coded labeling system and mounting hardware



CLEANING TOOL HOLDERS

- For mops, brooms, and other cleaning tools with handles
- Spring action grippers
- 4" (102mm) high
- Stainless steel
- Includes mounting hardware

No. 159-1006 24" (610mm) long with 3 holders

No. 159-1007 36" (914mm) long with 4 holders



CLEANING TOOL HOLDER

No. 159-1010

- For mops, brooms, and other cleaning tools with handles
- Wall mounted
- 4 movable hanger loops
- 18" (457mm) overall length
- Includes mounting hardware
- Heavy gauge chrome and steel

CLEANING TOOL HOLDER

No. 142-1157

- Anti-slip, spring action gripper holds from 7/8" to 1 1/4" (22mm to 32mm) diameter handles
- 1 7/16" H x 2 1/2" W x 1 1/4" D (40mm x 64mm x 32mm)
- Includes mounting hardware

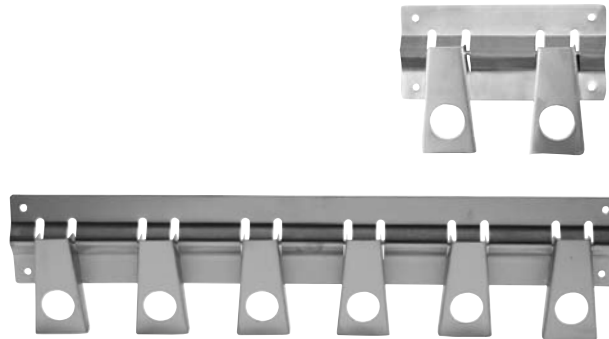

MOP AND BROOM HOLDERS

Organize your closet quickly and easily with these wall mounted holders. Holders come in 2 sizes to fit in any closet.

- Maximum 1 1/4" (32mm) diameter handles
- Stainless steel

No. 159-1139 Holds 2 cleaning tools

- 7 5/16" (192mm) overall length

No. 159-1140 Holds 6 cleaning tools

- 23 1/2" (597mm) overall length



TOOL HOLDER

No. 159-1144

- For mops, brooms, and other cleaning tools with handles
- Four adjustable and sliding holding brackets
- Includes mounting hardware
- 20" (508mm) long
- Aluminum



MOP AND BROOM HOLDERS by PRINCE CASTLE®

- Accommodates handles of different lengths and widths
- Includes mounting screws
- Heavy-duty aluminum

No. 171-1187 18" (457mm) long

- Prince Castle no. 918B

No. 171-1188 36" (914mm) long

- Prince Castle no. 936B

TOOL ORGANIZERS by UNGER®

Holds just about anything with a handle. Top opening allows greater versatility in hanging.

- Includes mounting hardware
- Aluminum

No. 262-1001 18" (457mm) long

No. 262-1068 36" (914mm) long



CLEANING TOOL HOLDERS



HOOK RACK

No. 159-1090

- 24" (610mm) long
- 4 adjustable hooks
- Includes mounting hardware
- Black plastic
- Pack of 2

No. 159-1093 Replacement 24" (610mm) bar
• Pack of 2



CLEANING TOOL HOLDER

No. 159-1089

- For mops, brooms, and other cleaning tools with handles
- 24" (610mm) long
- 4 adjustable holding brackets
- Includes mounting hardware

No. 159-1093 Replacement 24" (610mm) bar
• Pack of 2

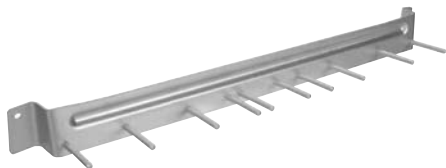

BRUSH RACK

Organizes a variety of brushes.

No. 142-1541

- 17" (432mm) overall length
- Holds up to 10 brushes
- Includes mounting screws

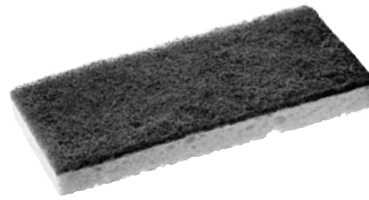

WALNUTPAD® SCRUBBING SPONGE

No. 159-1032

- 6¼" L x 3¼" W (159mm x 83mm)
- Contains organic crushed walnut shells
- Safe for virtually any surface
- USDA certified
- Sold individually

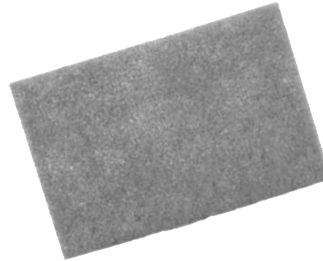

WALNUTPAD® SCRUBBING PAD

No. 159-1031

- 9" L x 6" W (229mm x 152mm)
- Contains organic crushed walnut shells
- Safe for virtually any surface
- USDA certified
- Pack of 20



PUMICE SCOURING STICK

No. 133-1195

- For cleaning metal, porcelain, and tile
- 6" x 1" x 1½" (152mm x 25mm x 38mm)
- 100% natural pumice



SCOTCH-BRITE™ EASY ERASING SPONGE by 3M™

No. 159-1054

- For cleaning stubborn stains, marks, scuffs, and dried-on messes
- Safe on any surface
- 4" x 5" (102mm x 127mm)
- Bag of 4



SCOTCH-BRITE™ POWER PAD by 3M™

No. 159-1058

- For cleaning heavily encrusted pots and pans, appliances, ceramic, glass, porcelain, and stainless steel
- 5" x 6¼" (127mm x 159mm)



HANDHELD BRUSHES WITH SCRAPER

- 6½" (165mm) long
- Includes scraper end
- White plastic

No. 159-1115 Red bristles

No. 159-1116 Blue bristles

No. 159-1117 Yellow bristles

No. 159-1118 White bristles

MULTI-PURPOSE BRUSHES



SCRUB BRUSH

No. 142-1379

- 6" (152mm) with 1 3/8" (35mm) white nylon bristles
- White plastic block



SCRUB BRUSH

No. 142-1380

- 9" (229mm) with 1" (25mm) natural bristles
- Hardwood block



TILE AND GROUT BRUSH

No. 142-1510

- May be used with tile and grout cleaner (No. 143-1067)
- Two threaded holes for accepting extension pole at two different angles
- 7 1/8" (200mm) long
- 1" (25mm) high white nylon bristles
- White polypropylene handle



MULTI-PURPOSE BRUSHES

- For valves, outlets, tanks, beverage dispensers, coffee urns, steam kettles, etc.
- 5" diameter x 6" long (127mm x 152mm) head with stiff, white nylon bristles
- White plastic handle

No. 142-1383 16" (406mm) long

No. 142-1384 30" (762mm) long



LONG HANDLE BRUSH

No. 159-1073

- 1 5/8" (41mm) long red nylon bristles
- 20" (508mm) long white plastic handle



SCRUB BRUSHES

TAN PLASTIC BLOCK

- 1 5/8" (41mm) high yellow plastic bristles

No. 142-1378 8" (203mm) long

No. 142-1377 20" (508mm) long

WHITE PLASTIC BLOCK

- 1 5/8" (41mm) white nylon bristles

No. 142-1376 8" (203mm) long

No. 142-1375 20" (508mm) long



DOODLEBUG® HARD SURFACE CLEANERS by 3M™

Say goodbye to crust and grime. These powerful products effectively tackle a variety of cleaning tasks.

No. 159-1055

- For use with 4 5/8" x 10" (117mm x 254mm) 3M™ cleaning pads
- Includes white polishing pad and brown scrubbing pad
- Omnidirectional swivel
- Attaches to standard threaded handle

REPLACEMENT PADS

No. 159-1056 White polishing

- For use on delicate surfaces like windows and ceramic tile
- For use with Doodlebug® pad holder
- 4 5/8" x 10" (117mm x 254mm)

No. 159-1057 Brown scrubbing

- For heavy-duty cleaning and stripping; also removes finish and wax build-up
- For use with Doodlebug® pad holder
- 4 5/8" x 10" (117mm x 254mm)

WINDOW AND FLOOR CLEANING



NEW

WINDOW BUCKET

No. 159-1130

- 18" L x 9 1/4" W x 9 5/8" D (457mm x 235mm x 244mm)
- White plastic handle
- Green plastic

WINDOW CLEANING KIT

No. 159-1133

- Kit includes: Bucket (No. 159-1130)
- Channel with rubber squeegee (No. 159-1126)
- Handle (No. 159-1125)
- Super "T" bar (No. 159-1128)
- Applicator sleeve (No. 159-1129)

NEW



CHANNELS

- Aluminum frame
- Rubber squeegee

No. 159-1126 12" (305mm) long

No. 159-1127 14" (356mm) long

NEW



SQUEEGEE

No. 159-1080

- 21 3/4" (552mm) long
- Black foam rubber



EXTENDER HANDLE

No. 159-1062

- 39 1/4" (997mm) long with 72" (1829mm) maximum extension
- Black plastic threaded tip
- Aluminum handle with a black rubber grip



SUPER "T" BAR

No. 159-1128

- Used with studloc pole (No. 159-1124)
- Swivel head
- 14" (356mm) long
- Aluminum

NEW



WINDOW CLEANING HANDLE

No. 159-1125

- Clamping jaws hold squeegee in place
- 8" L x 3 1/2" W (203mm x 89mm)
- Swivel head
- Black plastic

NEW



NEW

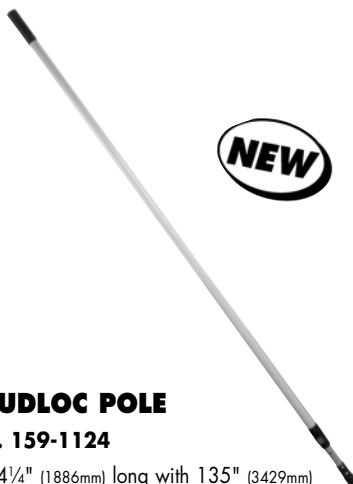

STUDLOC POLE

No. 159-1124

- 74 1/4" (1886mm) long with 135" (3429mm) maximum extension
- Male thread
- Includes red lock button for extending
- Black plastic threaded tip
- Yellow fiberglass pole

APPLICATOR SLEEVE

No. 159-1129

- Used with Super "T" Bar (No. 159-1128)
- 15" (381mm) long
- Purple cotton

NEW



NEW



FLOOR SQUEEGEE

No. 159-1123

- 23 1/2" (597mm) long
- Female thread
- Black rubber sponge

MAINTENANCE ACCESSORIES by UNGER®

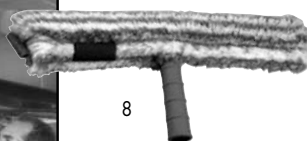

WINDOW SQUEEGEES AND HANDLES

SQUEEGEES

- No. 142-1065** 6" (152mm) squeegee
 - With stainless steel notched "S" channel
- No. 142-1066** 12" (305mm) squeegee
 - With stainless steel notched "S" channel
- No. 142-1067** 18" (457mm) squeegee
 - With stainless steel notched "S" channel

HANDLES

- No. 142-1064** Squeegee handle
 - For use with above window squeegees
- No. 142-1470** ErgoTec® squeegee handle
 - For use with above window squeegees
 - Ergonomically designed grip makes holding easier in wet or cold conditions
 - Improves control when cleaning in corners and along edges
 - Quick spring release allows for quick, easy rubber and channel changes

STRIP WASHERS

- No. 142-1414** Vice-Versa™ squeegee and strip washer
 - May be used with above squeegees
 - 14" (356mm) strip washer and squeegee in one
 - Attaches to standard broom thread handle (not included) (see No. 142-1402)
- No. 142-1425** Strip washer arm with sleeve
 - 14" (356mm) long
- No. 142-1426** Strip washer sleeve only
 - 14" (356mm) long
- No. 142-1471** Monsoon Plus™ Strip Washer
 - Extra heavy-duty fabric for maximum water holding and release capabilities
 - Sleeve has VELCRO® brand fastening, heavy-duty backing for longer wear, and a non-abrasive end pad for scrubbing power
 - 14" (356mm) long

WINDOW CLEANER

- No. 142-1482**
 - One tablet makes 2½ gal (9L)
 - Non-toxic, biodegradable, and contains no phosphates
 - 10 tablets individually packaged per pack

WINDOW CLEANING KIT

- No. 142-1575**
 - Kit includes: Vinyl/nylon case
 - 8' (2M) OptiLoc pole
 - 14" (356mm) original strip washer
 - Large sponge
 - Stainless steel squeegee handle
 - 6" (152mm), 12" (305mm), and 18" (457mm) "S" channels with ErgoTec® soft rubber blade
 - 36" (914mm) ErgoTec® replacement rubber
 - Trim 10 Scraper
 - Safety scraper with blade
 - FIXI-Clamp
 - Handi-Brush
 - Instructions

MAINTENANCE ACCESSORIES by UNGER®

FLOOR SQUEEGEES

WATERWAND FLOOR SQUEEGEES

- 2 rows of soft "moss" rubber for maximum water push
- With screw and locking socket
- Attach to standard tapered handle (not included) (see No. 142-1402)

1. **No. 142-1415** 18" (457mm) long
2. **No. 142-1475** 22" (559mm) long

SANITARY FLOOR SQUEEGEES

3. **No. 142-1476** Acme insert adaptor
 - Adapts locking sockets to accept threaded handles
4. **No. 142-1449** Squeegee with brush
 - Acid resistant, non-corroding polypropylene frame
 - 2 rows of soft "moss" rubber and two rows of heavy-duty bristles
 - Splash guard and female threads
 - 18" (457mm) long

AQUADOZER® FLOOR SQUEEGEES

- Ideal for moving large volumes of water, debris, scraps, even slush and snow
 - For most smooth surfaces, including coated or uncoated concrete, commercial graded carpet, and wood
 - Painted steel arm
5. **No. 142-1473** 24" (610mm) straight squeegee
 6. **No. 142-1474** 24" (610mm) curved squeegee

SPONGE

7. **No. 142-1412**
 - 8½" L x 3⅞" W x 2¾" H (216mm x 98mm x 70mm)

PRO BUCKET

Great for strip wipers—and other window cleaning tools!

8. **No. 142-1513**
 - 6 gal (23L) capacity with contoured graduation markings
 - Can accommodate up to 18" (457mm) squeegees
 - Molded-in pour spouts in opposite corners
 - 23" L x 11¼" W x 9¾" D (584mm x 298mm x 248mm)
 - Green polypropylene-copolymer with black handle

BUCKET DOLLY

9. **No. 142-1515**
 - Snaps onto bucket
 - Includes 4 swivel casters and bumper guards

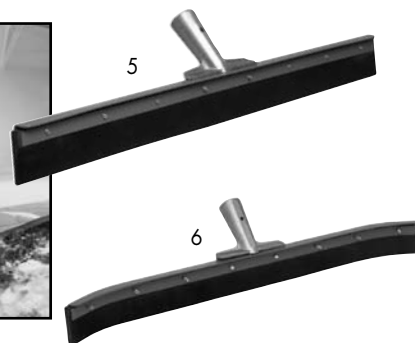
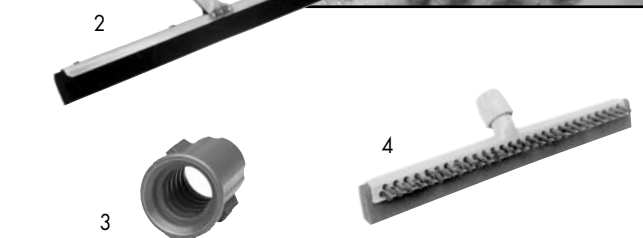

MAINTENANCE ACCESSORIES by UNGER®

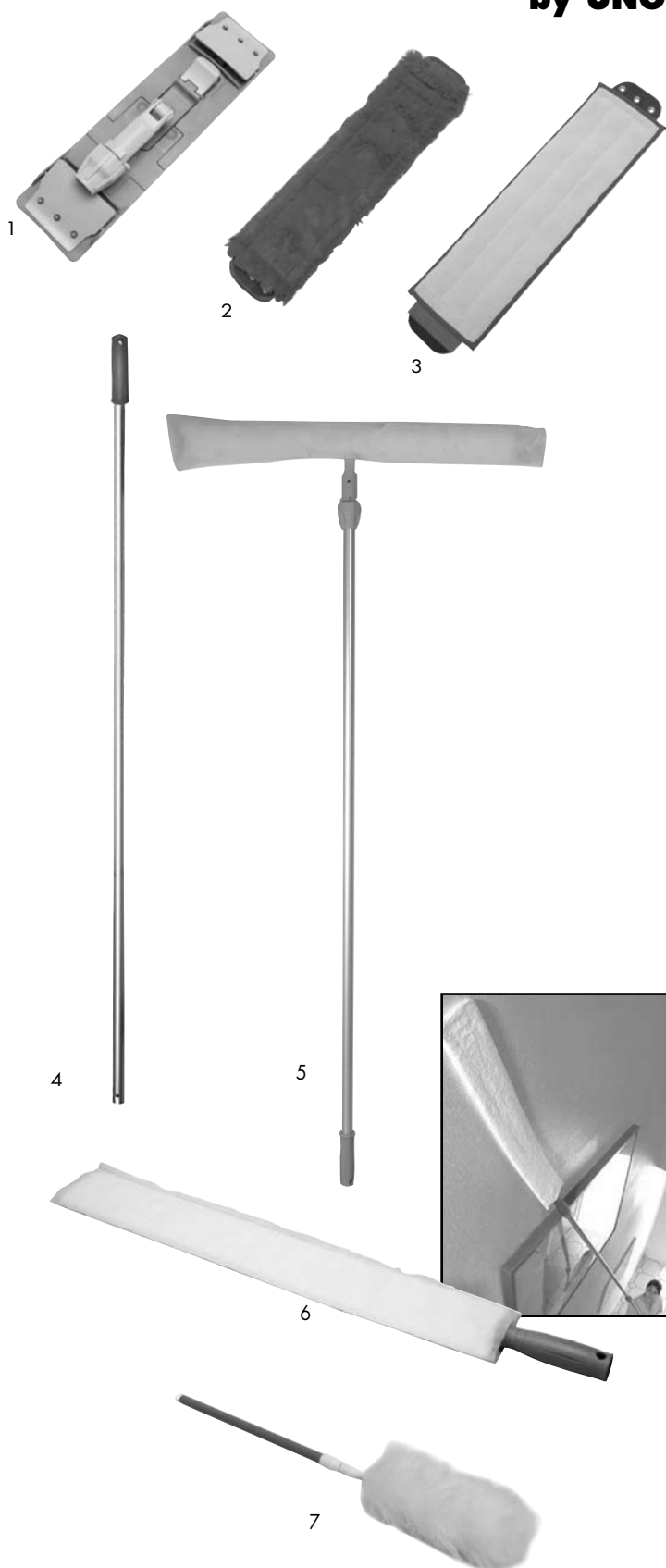

MICROFIBER MOPS AND HOLDER

1. **No. 142-1553** Holder only
 - 15¾" L x 4¼" W (400mm x 108mm)
 - Spring-loaded clamps
 - Removable pin clip for securing handle (No. 142-1552)
 - Gray plastic
2. **No. 142-1550** High pile mop
 - For heavy-duty cleaning
 - 18" L x 5" W (457mm x 127mm)
 - Red pad area
3. **No. 142-1551** Low pile mop
 - For damp mopping and faster drying time
 - 17" L x 4¾" W (432mm x 111mm)
 - Gray pad with red border

MOP HANDLE

4. **No. 142-1552**
 - 55" (1397mm) long
 - Aluminum pole with plastic grip

DRY/DAMP SWEEPER

5. **No. 142-1569**
 - 52" (1320mm) long aluminum handle
 - Includes one 24" (610mm) wide sweeper sleeve and five 24" (610mm) disposable sleeves

REPLACEMENT PARTS

- No. 142-1570** Sweeper sleeve only
- Plush fabric

- No. 142-1571** Disposable sleeve only
- Electrostatic
 - Pack of 50

TOTAL REACH® DUSTERPLUS FLEXIBLE DUSTER

Great for tight spaces—like underneath refrigerators

6. **No. 142-1511**
 - 26" L x 3½" W (660mm x 89mm)
 - Can be handheld or attached to extension poles (Nos. 142-1060, 142-1061, or 142-1479)
 - Includes 3½" x 26" (89mm x 660mm) washable microfiber sleeve and 3 disposable slide-on dust covers (No. 142-1512)

- No. 142-1512** Disposable dust cover only
- Pack of 10

PRO DUSTER EXTENDIBLE DUSTER

7. **No. 142-1565**
 - 35" (889mm) long with 60" (1524mm) maximum extension
 - Bendable head
 - Includes 1 electrostatic duster sleeve
 - Lambs wool

- No. 142-1566** Duster sleeve only
- Pack of 10

MAINTENANCE ACCESSORIES by UNGER®

CLEANING BRUSHES

- Can be used with telescoping extension poles, and aluminum handle (No. 142-1477)
 - Attach to standard broom thread handle (not included) (No. 142-1402)
1. **No. 142-1411** Ceiling fan brush
 - Ideal for ceiling fan blades, air vents, and other hard-to-reach places
 - 12" x 5" (305mm x 127mm) oval
 2. **No. 142-1472** Pipe brush
 - Ideal for removing dirt from pipes and other rounded surfaces
 - Heavy-duty galvanized wire and 49% horsehair bristles

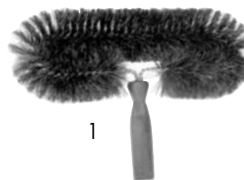

SCRAPERS

Removes gum, stickers, wax build-up, and caked-on dirt from vinyl, resilient tile, and hard flat surfaces. Angled heads give better performance, greater control, and strength. The blade's razor edge is excellent for scraping paint and tape, while the blunt edge can be used on cement, stucco, or delicate, uneven floors.

- Reversible 4" (102mm) blade has a blunt scraping edge and a razor-sharp edge
3. **No. 142-1534** Light-duty scraper
 - 48" (1219mm) long
 4. **No. 142-1573** Scraper
 - 12" (305mm) long
 - Aluminum handle with ergonomic non-slip grip
 5. **No. 142-1480** Short handle scraper
 - 7¾" (197mm) long
 - Can be used alone or attached to extension poles

No. 142-1574 Blade only

- Stainless steel
- Pack of 10



GRABBER

6. **No. 142-1058**
 - Ideal for picking up unsanitary, out-of-reach, or potentially harmful objects
 - 51" (1295mm) overall length
 - Zinc-plated steel



MAINTENANCE ACCESSORIES by UNGER®

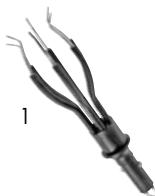

LIGHT BULB REMOVER

1. **No. 142-1069**
 - Adjustable fingers fit over bulb
 - Fits most bulbs up to 200 watt



BROKEN BULB REMOVER

2. **No. 142-1071**
 - Removes the base of broken light bulbs and flood lights
 - Insulated design
 - Unique broken glass catcher attached to base of tool



FLOOD LIGHT AND LARGE BULB REMOVER

3. **No. 142-1070**
 - Suction cups grab the bulb lens tightly
 - Fits most flood lights
 - Fits most 300 watt and larger light bulbs

TELESCOPING EXTENSION POLES WITH THREADED ADAPTOR TIP

4. **No. 142-1060** 8' (2438mm) extended length
 - 2-section pole
5. **No. 142-1479** 13' (3962mm) extended length
 - 2-section pole
6. **No. 142-1061** 14' (4267mm) extended length
 - 2-section pole

THREADED ADAPTOR TIP

7. **No. 142-1062**
 - Allows threaded accessories to be attached to extension poles

Note: Provided with all extension poles.

ALUMINUM HANDLE

8. **No. 142-1477**
 - 57" (1448mm) long
 - 2 handles in 1: 3° taper combined with threaded tip allows use with all products with a 3° taper or universal thread socket

WOOD HANDLE

- No. 142-1402**
- 54" (1372mm) long with tapered end (not shown)



MAINTENANCE ACCESSORIES

by UNGER®



The spray trigger and MicroWipe fit conveniently on the sprayer body when not in use.

SPRAY BOTTLE WITH BELT CLIP

Patented ergonomic design relieves stress and strain on hands, wrists, arms, shoulders, and back by transferring the weight of the spray bottle to the belt. No more wasted trips back to the cleaning cart.

No. 142-1530 Sprayer On A Belt

- Sprays at any angle
- Clips onto any belt for right- or left-hand use
- 36" (914mm) long extended reach
- 33 oz (976ml) bottle



SPRAY BOTTLE BELT

No. 142-1531

- For Sprayer On A Belt (No. 142-1530)
- Black nylon



MICROWIPES

Microfibers trap surface soil, remove bacteria, and absorb moisture better than cotton cloths and sponges. Combine with the Unger Sprayer On A Belt for fast and efficient cleaning.

- Use for daily dusting and light-duty soil
- Wash and reuse up to 500 times
- 16" x 16" (406mm x 406mm)
- 3.3 oz (1100ml) absorption

No. 142-1532 Red

No. 142-1533 Green

No. 142-1562 Blue

No. 142-1563 Yellow

HANDHELD INSPECTION KIT

Great for employee training and spot inspections. Mark the surface to be cleaned with included invisible ink pen. Then inspect area with the UV blacklight after cleaning is completed. If the mark is still there, the surface is still dirty.

No. 142-1516

- Pocket size
- Requires 4 AA batteries (not included)

REPLACEMENT PARTS

No. 142-1517 Invisible ink pen

No. 253-1241 AA battery





KLEEN BRUSH® HAND AND NAIL CLEANING SYSTEM by SAN JAMAR®

No. 150-6028

- Attaches to any gooseneck faucet to keep nail brush handy for use
- Innovative design helps wash dirt and bacteria down the drain
- Rotates horizontally for easy cleaning of left or right hand
- Flips up out of the way when not in use
- Brush can be easily removed for deep cleaning in a dishwasher
- Holder accommodates a variety of brush brands
- Can be used with disposable hand and nail brush (No. 150-6047)



HAND AND NAIL BRUSH

No. 142-1438

- Ideal for removing dirt and bacteria from cuticles and fingernails

HAND AND NAIL BRUSH AND SOAP BOTTLE

Rid those germs with this handy, uniquely designed item.

No. 142-1453

- 3/4" (19mm) bristle brush attached
- 4 oz (118ml) plastic bottle with dispensing cap
- Soap sold separately



HAND AND NAIL BRUSH KIT

No. 142-1539

- Kit includes:
Hand & nail brush (No. 142-1438)
Adhesive-backed wall hook
Bungee cord with metal ring
Instruction label in English and Spanish



DISPOSABLE HAND AND NAIL BRUSH

No. 150-6047

- Fits on Kleen-Brush® System (No. 150-6028)
- Blue plastic
- Pack of 36

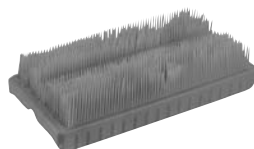

Have You Tried Ordering Online at FMPONLINE.COM?



It's Fast & Easy!

- 12,000 Items Listed
- Point & Click Ordering
- Custom Favorite Items Menu
- Order Tracking
- 24-Hour Ordering
- Order History
- Complete Search
- Constantly Updated
- Quick Order Option
- Closeouts
- Specials



TRIPLE TROLLEY UTILITY CART by RUBBERMAID®

No. 262-1126

- Model 4401
- 3-position handle allows for pushing, pulling, and folding flat
- Durable, non-skid foam deck features cut-outs for comfortable carrying
- 5" (127mm) diameter wheels
- 32½" L x 20½" W (826mm x 521mm)
- 400 lb (181kg) load capacity
- Ships UPS

REPLACEMENT CASTERS

- 5" (127mm)

No. 262-1055 Rigid caster

- Rubbermaid no. 4501L1

No. 262-1056 Swivel caster

- Rubbermaid no. 4501L2



LAUNDRY CART

No. 141-2016

- 6-bushel capacity
- Collapsible for easy storage
- Includes laundry bag and 4 swivel casters
- Chrome-plated steel frame

No. 141-2017 Laundry bag only

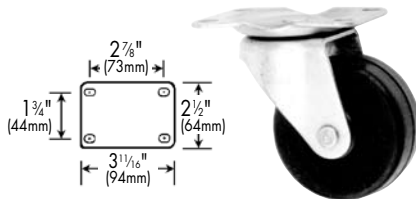

CASTER FOR RUBBERMAID® UNIVERSAL DRUM DOLLY

No. 262-1012

- Model 2650
- 3" (76mm) wheel diameter
- Includes four #10 x 1" long self-tapping screws

SLIM JIM® TROLLEY by RUBBERMAID®

Compact, interlocking trollies help you move multiple containers in one trip.

No. 262-1154

- For use with container models 3540, 3541, and 3554
- 200 lb (91kg) maximum capacity
- Black plastic
- Rubbermaid no. 3551-88



WASHROOM & MAINTENANCE

CASTER FOR OLD STYLE RUBBERMAID® BRUTE® DOLLY

No. 262-1008



BRUTE® DOLLY by RUBBERMAID®

No. 262-1007

- For 20, 32, 44, and 55 gal (76, 121, 167, and 208L) containers
- Rubbermaid no. 2640



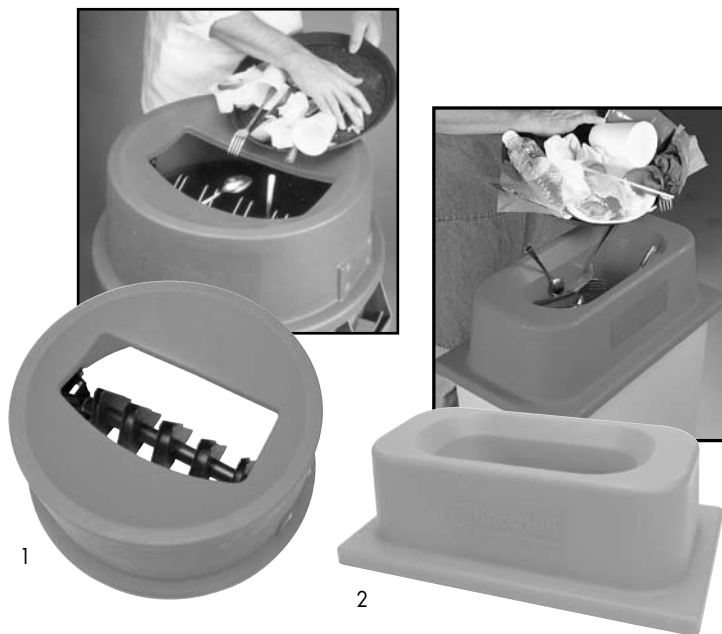

MAGNETIC TRASH LIDS by SAN JAMAR®

- Helps reduce flatware loss by up to 75%
- Trash passes through strong magnets located in lid
- Dishwasher safe
- Red plastic

1. **No. 150-6027** Round
 - Fits 20 gal (77L) containers
1. **No. 280-1276** Round
 - Fits 32 gal (121L) containers
2. **No. 150-6009** Rectangular
 - Fits 23 gal (87L) containers

Note: Lids will not work on 18/8 stainless steel flatware.

TRASH BINS

- 43½" H x 19½" W x 19½" D
(1105mm x 495mm x 495mm)
- 46" H x 19½" W x 19½" D
(1168mm x 495mm x 495mm) with tray holder
- 30 gal (114L) capacity
- Reusable, rigid plastic liner included
- Self-closing hinges
- High density polyethylene gray or dark brown push doors with routed "Thank You," "Trash Only" or blank
- ¾" (19mm) laminate finish particle board
- Unit available in 3 laminate finishes: gray, oak, and walnut
- Available with or without tray holder

SPECIAL ORDER ONLY— CALL FOR INFORMATION

Must specify:

1. Color of unit
2. Color of door
3. Message
4. With or without tray holder



LITTER COMPACTING TOOL

No. 171-1139

- For compacting trash containers
- 36" (914mm) long handle
- Nickel-plated steel



TRASH BIN LID by PRINCE CASTLE

No. 171-1150

- For use on trash bin with a 20" x 20" (508mm x 508mm) opening
- Swing-door opening
- Brown, heavy-duty plastic
- Prince Castle no. 115GO

SANIT-GRAB



SANITARY TRASH BIN HANDLE



*The ultimate in clean trash disposal
Easy to install—comes complete with hardware*

No. 280-1240

- Convenient—makes trash disposal a breeze
- Helps prevent messy spills
- Coconut color complements any decor
- Adaptable to any lid
- Lightweight and durable
- Easy to clean
- Side mounted for maximum disposal area
- Lexan®

FLOOR SAFETY

Decreases
drying time by
up to 90%

1
YEAR
WARRANTY



HURRICANE™ CORDLESS FLOOR DRYER

Dries wet floors in a flash, creating a safer environment for customers and employees.

No. 159-1141

- Ideal for high traffic areas
- Dries floors 360° around unit and up to 15' (4.5M) in diameter
- Runs up to 12 hours on a replaceable, rechargeable battery pack
- Features a battery level indicator with light and alarm, and a battery circuit saver
- Battery pack can be charged internally or removed and charged separately to avoid taking dryer out of service
- Includes 36" (914mm) high, stackable safety cone; fan; battery; and charger
- OSHA and ANSI compliant



1
YEAR
WARRANTY



FLOOR AND CARPET DRYER

Ideal for carpets, hard floors, and upholstery. Motor generates up to 4100 CFM to slash dry time in half and features 3 speed settings. Exclusive interlocking design enables safe stacking and securing of multiple machines for increased airflow. Protective screens at all openings promote safe operation.

No. 159-1033

- 20" H x 17" W x 15" D (508mm x 432mm x 381mm)
- 120 volt, 1 horsepower motor
- Built-in cord wrap
- Lightweight molded polyethylene

CAUTION SIGN

No. 262-1000

- "Caution" written in English, French, and Spanish
- Yellow with black and red lettering and graphics
- Hinge bracket for better stability

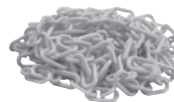

PLASTIC CHAIN WITH SIGNS

No. 159-1037

- For use with caution cone (No. 159-1036) to block off a specific area
- Bright yellow plastic 20' (6M) barrier chain
- 2 double-sided 9" (229mm) red caution signs that can be attached to top of cones

POP-UP SAFETY CONES

- 21" (533mm) wide
- Multi-lingual "Caution" imprint
- Folds compactly for easy storage
- Includes storage tube for wall mounting
- Yellow with black lettering

1. No. 262-1147 20" (508mm) high
• 17½" (445mm) deep
2. No. 262-1148 29" (737mm) high
• 21" (533mm) deep



CAUTION CONE

No. 159-1036

- Universal "Caution Wet Floor" symbol on all 3 sides
- 41" (1041mm) high
- Yellow plastic with red outlines





LED LIGHTED EXIT SIGN

No. 253-1249

- Can be wall or ceiling mounted
- Double-faced
- White body with red lettering
- 120 volt



**LED LIGHTED EXIT SIGN
WITH BATTERY BACKUP**

No. 253-1250

- 90-minute battery backup power supply with 2 adjustable emergency lights
- Can be wall or ceiling mounted
- Double-faced
- White body with red lettering
- 120/277 volt



EMERGENCY EXIT SIGN

No. 280-1314

- White with red lettering
- 7" x 10" (178mm x 254mm)
- Pressure sensitive vinyl with adhesive backing



**LIGHTED EXIT SIGN
CONVERSION KIT**

Lights Brighter! Lasts Longer!

Bulbs exceed illumination requirements for classified product listings. The multi-placement of 23 high intensity LEDs evenly optimizes light output within all areas of the exit sign. The Lighted Exit Sign Lamp Conversion Kit is ETL listed and tested to standard UL924 and NFP Life Safety Code 101.

No. 253-1269

- Can be used to retrofit existing red letter exit signs
- Easily fits where 20T6 1.2 watt incandescent bulbs have previously been used
- Includes 2 arrays of 23 red light emitting diodes on intermediate screw type bases, 2 candelabra bases, and 2 bayonet bases

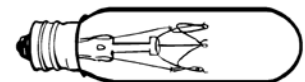

REPLACEMENT BULB

No. 253-1251

- For use on older style emergency exit signs not using LED bulbs
- 145 volt, 15 watt
- Candelabra base



**LOCKING WALL
THERMOSTAT COVER**

No. 280-1040

- For thermostats up to 3½" H x 6¼" W x 2¾" D (89mm x 159mm x 70mm)



**IF YOU DON'T SEE AN
ITEM YOU NEED...
CALL US!**

ADA SIGNS



WOMEN'S RESTROOM WITH BRAILLE

No. 280-1199

- Raised symbols and lettering
- 6" x 9" (152mm x 229mm)
- Black and white
- Plastic with adhesive back



MEN'S RESTROOM WITH BRAILLE

No. 280-1198

- Raised symbols and lettering
- 6" x 9" (152mm x 229mm)
- Black and white
- Plastic with adhesive back



RESERVED PARKING

- Blue ADA symbol, green lettering on white
- Steel

No. 280-1212

12" x 18" (305mm x 457mm)

No. 280-1213

18" x 24" (457mm x 610mm)



WOMEN'S RESTROOM WITH BRAILLE

No. 280-1202

- Raised symbols and lettering
- 6" x 9" (152mm x 229mm)
- Black and white
- Plastic with adhesive back



MEN'S RESTROOM WITH BRAILLE

No. 280-1201

- Raised symbols and lettering
- 6" x 9" (152mm x 229mm)
- Black and white
- Plastic with adhesive back



RESERVED PARKING

No. 280-1211

- 12" x 18" (305mm x 457mm)
- Blue ADA symbol, green lettering on white
- Steel



RESTROOM WITH BRAILLE

No. 280-1200

- Raised symbols and lettering
- 6" x 9" (152mm x 229mm)
- Black and white
- Plastic with adhesive back



NO SMOKING WITH BRAILLE

No. 280-1208

- Raised symbols and lettering
- 6" x 9" (152mm x 229mm)
- Black and white
- Plastic with adhesive back



ACCESSIBLE WITH BRAILLE

No. 280-1195

- Raised symbols and lettering
- 6" x 9" (152mm x 229mm)
- Black and white
- Plastic with adhesive back



WASHROOM & MAINTENANCE

ADA SYMBOL

No. 280-1128

- 3" x 3" (76mm x 76mm)
- Blue with white symbol
- Plastic with adhesive back



ACCESSIBLE

No. 280-1129

- 6" x 9" (152mm x 229mm)
- Blue and white
- Plastic with adhesive back



RESTROOMS

No. 280-1196

- 7" x 14" (178mm x 356mm)
- Blue and white
- Plastic

PARKING ONLY

No. 280-1127

- 6 1/2" x 14" (165mm x 356mm)
- Blue and white
- Aluminum

WALNUT FINISH SIGNS



EMPLOYEES ONLY

No. 280-1126

- 3" x 8" (76mm x 203mm)
- Walnut finish with white lettering
- Durable plastic with adhesive back



NO SMOKING

No. 280-1106

- 2¾" x 8¼" (70mm x 210mm)
- Walnut finish with white lettering
- Durable plastic with adhesive back



MEN

No. 280-1098

- 2¾" x 8¼" (70mm x 210mm)
- Walnut finish with white lettering
- Durable plastic with adhesive back



RESTROOMS

No. 280-1096

- 2¾" x 8¼" (70mm x 210mm)
- Walnut finish with white lettering
- Durable plastic with adhesive back



ARROW

No. 280-1111

- 2¾" x 8¼" (70mm x 210mm)
- Walnut finish with white lettering
- Durable plastic with adhesive back



THANK YOU FOR NOT SMOKING

No. 280-1105

- 2¾" x 8¼" (70mm x 210mm)
- Walnut finish with white lettering
- Durable plastic with adhesive back



WOMEN

No. 280-1099

- 2¾" x 8¼" (70mm x 210mm)
- Walnut finish with white lettering
- Durable plastic with adhesive back



WASH HANDS

No. 280-1097

- 2¾" x 8¼" (70mm x 210mm)
- Walnut finish with white lettering
- Durable plastic with adhesive back

MISCELLANEOUS SIGNS



EMPLOYEES ONLY

No. 280-1160

- 3" x 9" (76mm x 229mm)
- Black with white lettering
- Durable plastic with adhesive back

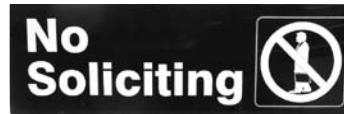

NO SOLICITING

No. 280-1135

- 3" x 9" (76mm x 229mm)
- Black with white lettering
- Durable plastic with adhesive back



WASH HANDS

No. 280-1133

- 3" x 9" (76mm x 229mm)
- Black with white lettering
- Durable plastic with adhesive back



NO SMOKING

No. 280-1139

- 3" x 9" (76mm x 229mm)
- Black with white lettering
- Durable plastic with adhesive back



NO SMOKING

No. 280-1107

- 2 3/4" x 8 1/4" (70mm x 210mm)
- Bright red with white lettering
- Durable plastic with adhesive back

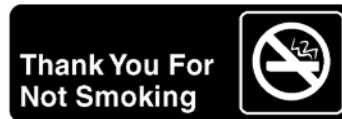

THANK YOU FOR NOT SMOKING

No. 280-1138

- 3" x 9" (76mm x 229mm)
- Black with white lettering
- Durable plastic with adhesive back

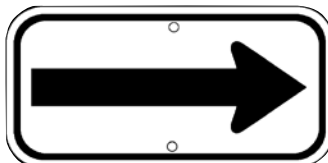

ARROW

No. 280-1197

- 6" x 12" (152mm x 305mm)
- White with blue arrow
- Steel

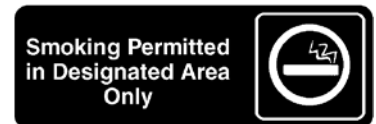

SMOKING PERMITTED

No. 280-1142

- 3" x 9" (76mm x 229mm)
- Black with white lettering
- Durable plastic with adhesive back



RESTROOMS

No. 280-1132

- 3" x 9" (76mm x 229mm)
- Black with white lettering
- Durable plastic with adhesive back



WOMEN

No. 280-1137

- 3" x 9" (76mm x 229mm)
- Black with white lettering
- Durable plastic with adhesive back

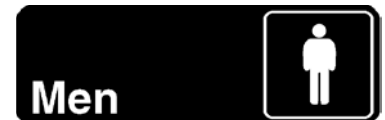

MEN

No. 280-1136

- 3" x 9" (76mm x 229mm)
- Black with white lettering
- Durable plastic with adhesive back

MISCELLANEOUS SIGNS



NO CHECKS

No. 280-1146

- 3" x 9" (76mm x 229mm)
- Black with white lettering
- Durable plastic with adhesive back



LOST/STOLEN ARTICLES

No. 280-1147

- 3" x 9" (76mm x 229mm)
- Black with white lettering
- Durable plastic with adhesive back



NO SMOKING

No. 280-1164

- 6" x 9" (152mm x 229mm)
- Black sign with white lettering
- Plastic with adhesive back



NO EXIT

No. 280-1151

- 3" x 9" (76mm x 229mm)
- Black with white lettering
- Durable plastic with adhesive back

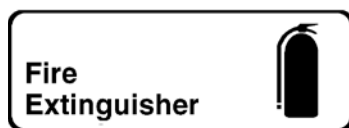

FIRE EXTINGUISHER

No. 280-1143

- 3" x 9" (76mm x 229mm)
- White with red lettering
- Durable plastic with adhesive back



FIRE EXTINGUISHER

No. 280-1162

- 6" x 9" (152mm x 229mm)
- White sign with red lettering
- Plastic with adhesive back

ENGLISH/SPANISH SIGNS



WOMEN/DAMAS

No. 280-1190

- 3" x 9" (76mm x 229mm)
- Black with white lettering
- Plastic with adhesive back



MEN/CABALLEROS

No. 280-1189

- 3" x 9" (76mm x 229mm)
- Black with white lettering
- Plastic with adhesive back



WASH HANDS (IN SPANISH)

No. 280-1193

- 3" x 9" (76mm x 229mm)
- Black with white lettering
- Plastic with adhesive back



RESTROOMS

No. 280-1165

- 6" x 9" (152mm x 229mm)
- Black sign with white lettering
- Plastic with adhesive back



INDUSTRIAL HOT WATER HOSES

- Crushproof brass garden hose fittings
- Withstands temperatures to 180°F
- 500 lb burst strength
- Double spiral reinforcement for cut resistance
- Red, heavy-duty rubber

No. 159-1004 5/8" ID x 50' roll

No. 159-1011 3/4" ID x 50' roll



STRAHMAN HOSE RACK

No. 159-1016

- Stainless steel
- Holds up to 50' (15240mm) of hose



HOSE CARRIER AND HOLDER

Store and carry hoses neatly and tangle-free.

Fits easily around a 100' (30480mm) garden hose. The easy-to-use hook and loop closures adjust to fit most hose sizes. Can also be used for extension cords, tubing, etc.

No. 280-1177

- Tested up to 50 lb (23kg)
- 3" (76mm) wide
- Strong, reinforced black nylon with double stitched nylon binding and reinforced handle



FLEXIBLE SAFETY GOGGLES

No. 142-1100

- Ventilated to prevent fogging
- Fits contour of face
- Meets ANSI and OSHA requirements
- One size fits all



BACK SUPPORT BELTS

- Provides comfort and support when lifting heavy objects
- For correct fit, measure around hips, just below navel
- Shoulder straps included
- Black

No. 280-1510 X-Small

- Fits hips 23" to 27" (584mm to 686mm)

No. 280-1511 Small

- Fits hips 28" to 32" (711mm to 813mm)

No. 280-1253 Medium

- Fits hips 33" to 38" (838mm to 965mm)

No. 280-1252 Large

- Fits hips 39" to 44" (991mm to 1118mm)

No. 280-1251 X-Large

- Fits hips 45" to 49" (1143mm to 1245mm)

No. 280-1512 XX-Large

- Fits hips 50" to 54" (1270mm to 1372mm)

**Are You
Missing the
FAX?**



**Take advantage
of this
FREE SERVICE...
Get new product
updates &
exclusive savings
opportunities!
Call sales to register
for this service.**

ASH TRAYS/CIGARETTE RECEPTACLES



SMOKER'S OUTPOST® CLASSICO™ RECEPTACLE

Extinguishes cigarettes quickly with a patented oxygen-restricting design. Molded-in keyhole cigarette opening prevents unwanted litter from entering. Powder coat finish won't rust or discolor pavement. Durable steel construction won't melt.

No. 159-1094

- 40" H x 15" W x 15" D
(1016mm x 381mm x 381mm)
- Includes removable bucket with handle
- Steel with pewter textured finish



SMOKER'S OUTPOST® WALL MOUNTED RECEPTACLE*

Keep your establishment litter-free with this space-saving, wall-mountable ash tray. Features removable top for emptying and perforated metal cigarette extinguisher tab.

No. 159-1096

- 16" (406mm) high
- Includes mounting bracket
- Painted silver aluminum finish

***NEW Swivel-lock Smoker's Outpost Vandal Proof Receptacles are Available. Ask Your Sales Associate for Details.**



SMOKER'S OUTPOST® SITE SAVER® RECEPTACLE

Extinguishes cigarettes quickly with a patented oxygen-restricting design. Lid attaches to base with an airtight snap-lock closure.

No. 141-2038

- 42" H x 10¾" W x 10¾" D
(1067mm x 273mm x 273mm)
- Includes 1 gal (3.8L) steel pail liner with handle
- Tie-down rings can be used to secure base to location
- Durable, weather resistant beige polyethylene



ASH TRAY

No. 141-1120

- Removable pan
- 7½" H x 7¾" D (191mm x 197mm)
- Wall mount
- Stainless steel



ASH TRAY

No. 141-1121

- Hinged top
- Removable pan
- 2¼" H x 4¼" D (57mm x 108mm)
- Wall mount
- Satin chrome finish with hinged bracket

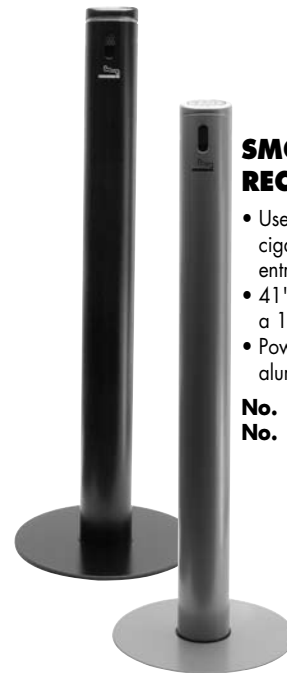

SMOKE STAND RECEPTACLES

- Used to extinguish cigarettes at building entrances
- 41" (1041mm) high with a 14" (356mm) base
- Powder-coated aluminum

No. 159-1142 Black

No. 159-1143 Silver



URN TYPE ASH TRAYS

- 20" H x 10" D
(508mm x 254mm)
- Chrome-plated top with painted barrel

No. 141-1117

Black wrinkle finish

No. 141-1118

Brown wrinkle finish

ASH/TRASH RECEPTACLE by RUBBERMAID®

Its elegant design is crafted with a mirror brass finish on both the top and bottom. Base ring helps protect carpeting and floors. For indoor use only.

No. 262-1159

- 27" H x 10" OD
(686mm x 254mm)
- 5½" (140mm) ID trash disposal opening with vinyl trim
- 3½ gal (13.2L) Germ-Fighter® rigid plastic liner
- Sand holding top
- Black heavy gauge fire safe steel construction



HAND CLEANERS



HAND CLEANING WIPES

No. 143-1097

- Contain antibacterial Goop citrus cleaner
- 40 count wipes measuring 8" x 7" (203mm x 178mm)
- Cap dispenses one wipe at a time



GOJO® NATURAL ORANGE HAND CLEANER

No. 143-1021

- For use with or without water
- Removes tough grease and grime while conditioning skin
- Includes removable brush to help clean underneath fingernails and cuticles
- 14 oz (414ml)

SEALANTS

SILICONE SEALANTS

- 10.3 oz (305ml) cartridge
- Rated from -80° to 302°F (-62° to 150°C) in food contact areas
- Rated from -80° to 400°F (-62° to 204°C) in non-contact areas
- FDA approved

No. 143-1053 Clear

No. 143-1054 Aluminum

No. 143-1056 White



SILICONE SEALANT

No. 143-1057

- Clear
- 3 oz (89ml) tube
- Rated from -60° to 450°F (-51° to 232°C)

HIGH TEMPERATURE RED SILICONE SEALANT

No. 143-1055

- 10.3 oz (305ml) cartridge
- Rated to 500°F (260°C)
- FDA approved



EPOXY PUTTY

Mixes like putty, hardens like steel; it can be sawed, drilled, and tapped. Works on most metals, wood, masonry, ceramics, glass, plastic, or porcelain. Sets in 5 minutes—even under water. The one-piece formula leaves no leftovers and no mess.

- 4 oz (114g) tube

No. 142-1128 Gray/green

No. 142-1437 Aquamend

LIQUID WELD EPOXY

No. 143-1065

- Super strong bond will attach or seal just about anything
- Can be machined
- Waterproof
- Epoxy adhesive
- Each tube is 1 oz (28g)



PAINT



RUST PREVENTIVE ENAMEL PAINT

No. 143-1047

- Silver hammered finish



HIGH TEMPERATURE ALUMINUM PAINT

No. 143-1051

- Rated to 1000°F (538°C)



ZINC GALVANIZE SPRAY

No. 143-1027

- A hard zinc coating that bonds itself to the surface of metals
- Resistant to salt spray; protects against rust and corrosion

STAINLESS STEEL SPRAY PAINT

No. 143-1043

Provides a hard, satin finish that resists abrasion and impact. Tough, scrubbable, durable. It is excellent for surfaces that are subject to punishment.

- Rated to 500°F (260°C)



HIGH TEMPERATURE BLACK PAINT

No. 143-1050

- Rated to 1200°F (649°C)



SPRAY PAINT

No. 143-1041

- Glossy white



SPRAY PAINTS

- No. 143-1042 Chrome aluminum
- No. 143-1048 Dark gloss gray
- No. 143-1044 Flat black
- No. 143-1046 Gloss black
- No. 143-1045 Primer gray

Aerosol cans cannot ship by air.

CLEANING/POLISHING ITEMS



STAINLESS STEEL POLISH

- Cleans, polishes and protects stainless steel, Formica®, porcelain, fiberglass, enamel, plastic, etc.
- Removes greasy film, water marks, and fingerprints
- Repels water

No. 143-1071 10 oz (283g) spray

No. 143-1072 1 qt (946ml) can

No. 143-1075 1 gal (3785ml) can



STAINLESS STEEL CLEANER AND POLISH

No. 143-1052

- Cleans and polishes all metal
- 15 oz (425g)



SCRUBS® CLEANING AND POLISHING CLOTHS

No. 143-1094

- Cleans, polishes, and protects brass, chrome, stainless steel, and fiberglass
- Pre-moistened with a low ammonia polishing formula
- Non-scratching abrasive cloth
- 11" x 8" (279mm x 203mm) cloths
- Resealable pack of 18

FLITZ® PASTE METAL/PLASTIC POLISH

No. 143-1008

- Cleans, polishes, and seals to let shine last longer
- Works on aluminum, bronze, chrome, copper, fiberglass, gold, plastic, silver, and stainless steel
- Non-flammable and non-toxic
- 1.76 oz (50g) tube



FLITZ® LIQUID POLISH

No. 143-1077

- Cleans, polishes, and seals for a long-lasting shine
- Works on aluminum, bronze, chrome, copper, fiberglass, gold, plastic, silver, and stainless steel
- Non-flammable and non-toxic
- Concentrated formula goes 3 times farther than other liquids
- 7.6 oz (225ml) bottle

Aerosol cans cannot ship by air.

CLEANERS



BEFORE

AFTER



CARBON REMOVER

The easy way to clean pans and griddles.

Cleans stoves, grills, steam cookers, ovens, skillets, pots, pans, deep fat fryers and aluminum utensils. Soaks off encrustations without scraping, scrubbing, or scouring.

- Semi-paste

No. 143-1092 Pint (473ml) can

No. 143-1095 19 oz (539g) aerosol spray can

No. 143-1070 Quart (946ml) can

No. 143-1101 Gallon (4L) can

GRAFFITI REMOVER

No. 143-1009

- Removes stains, writing, and graffiti from hard surfaces
- For use on brick, tile, metal, glass, marble, and Formica® surfaces
- 17 oz (482g)



CHEWING GUM REMOVER

No. 143-1022

- Removes chewing gum, candle wax, acrylic latex paint splatters, etc.
- For use on carpeting, upholstery, fabrics, and all hard surfaces
- 5.5 oz (156g)



ORANGE POWER® LIQUID DEGREASER

No. 143-1088

- Contains all natural citrus extracts
- For cleaning, degreasing, and deodorizing
- Strong, clean citrus odor
- Non-corrosive and safe for all metal surfaces, tile, vinyl, Formica®, carpets, upholstery, etc.
- Biodegradable
- 20 oz (591ml) container makes up to 10 gal (38L)

GRILL AND BARBECUE CLEANER

Dissolves grease and carbon deposits from grills, barbecues, grates, drip pans, ovens, smokers, and more.

No. 143-1076

- Non-abrasive, non-acid
- Biodegradable
- 22 oz (651ml) spray bottle



OVEN CLEANER

No. 143-1025

- Spray on and wipe clean
- Use on warm or cold ovens
- USDA authorized
- 18 oz (510g)



Aerosol cans cannot ship by air.

CLEANERS



ICE MACHINE CLEANER

No. 143-1001

- Concentrated, fast-acting cleaner
- Ideal for use where scale deposits are a problem
- Can also be used on coffee urns and other equipment
- Contains phosphoric acid
- 8 oz (237ml)



NICKEL-SAFE ICE MACHINE CLEANER

Fast acting cleaner with ingredients for use on nickel- and tin-plated equipment.

No. 143-1002

- Contains phosphoric acid
- 8 oz (237ml)



SOFT SERVE ICE CREAM MACHINE CLEANER

No. 143-1098

- 8 oz (237ml) bottle
- Sold in box of 2



DISSOLVE DESCALER

No. 165-1039

- Removes scale, lime, rust, and other water formed deposits on steamers
- 1 gal (4L)



SCALE KLEEN™ SCALE REMOVERS

- Ideal for deliming appliances that use water
- Granulated formula
- Non-corrosive, non-toxic, and biodegradable

No. 143-1091 1.75 oz (50g)

No. 117-1196 2.2 lb (1kg)

No. 117-1197 7 oz (198g)



DESCALER

No. 133-1101

- Hangs in boiler compartment of steamers
- Helps protect elements and other internal parts from scale build-up

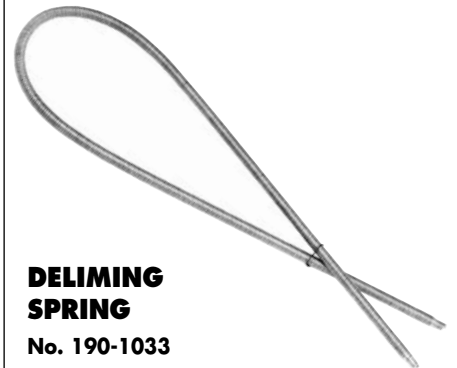

DELIMING SPRING

No. 190-1033

- ¼" D x 20" L (6mm x 508mm)
- Stainless steel

CLEANERS

**BLOWOUT REFRIGERATION
CONDENSER COIL CLEANER**
No. 143-1090

- High pressure spray removes grease, dust, and dirt without rinsing
- 20 oz (567g) aerosol can

**Aerosol cans cannot
ship by air.**

LIQUID COIL CLEANER
No. 143-1079

- Quickly dissolves grease, lint, tar, and other substances
- Easy to use and will not damage or corrode aluminum or soft metals
- Foaming action
- Non-acid, alkaline base
- Biodegradable
- 1 qt (946ml) of concentrate (makes 2 gal (7.6l))

POWDERED COIL CLEANER

Pushes dirt and grease to the coil surface where it can be rinsed away with water. Convenient to use—just mix with 1 gallon of water.

No. 143-1100

- Foaming action
- Non-acidic, alkaline base
- Non-toxic and biodegradable
- 8 oz (227g)

DRAIN AND TRAP DEODORIZER

Specially formulated for the institutional foodservice and hospitality industry.

No. 143-1083

- A fine white granular powder which oxidizes odors without bleach, disinfectants, or harsh chemicals
- Eliminates odors from floor and sink drains in foodservice areas
- Particularly effective on recurring, offensive odors from bar areas
- 4 1/2 lb (2kg) container

CHEMICAL PUMP DISPENSER
No. 280-1273

- For use with 1 gal (4l) bottles, 5 gal (19l) pails, or 55 gal (208l) drums
- Dispenses 1 oz (30ml) of soap, cleaner, degreaser, sanitizer, soap degrader, or grease trap treatment
- Mounts on wall or sink
- Includes pump and 8' (2438mm) of polyvinyl tubing
- Stainless steel and plastic pump

GREASE TRAP TREATMENT
No. 143-1081

- Specially formulated bacterial augmentation product for the institutional foodservice and hospitality industry—does not contain enzymes
- Designed for many types of sewage and wastewater systems where large amounts of food oil and grease occur
- Very effective in grease traps, septic tanks, cesspools, lift stations, pipes, and traps
- Reduces wastewater surcharges associated with high grease loads by biologically degrading them
- 1 gal (4l)

CLEANERS



WINDOW CLEANER

No. 142-1482

- 1 tablet makes 2½ gal (10L)
- Non-toxic, biodegradable, and contains no phosphates
- 10 tablets individually packaged per pack



GLASS AND PLASTIC CLEANER

No. 143-1059

- For use on glass, plastic/acrylic, Formica®, Plexiglas®, brass, stainless steel, chrome and many other materials
- Cleans and polishes without streaking
- 19 oz (539g) can



GLASS AND PLASTIC CLEANER

No. 143-1084

- Cleans and polishes glass, plastic/acrylic, Formica®, Plexiglas®, stainless steel, chrome and many other materials
- Non-ammoniated, low VOC formula
- Anti-fog, anti-static
- Does not contain CFCs
- 19 oz (539g) can

Aerosol cans cannot ship by air.



TILE AND GROUT CLEANER

No. 143-1067

- Cleans soap residue and other stains from tile, grout, and other non-porous surfaces
- Concentrated
- Non-acid
- Biodegradable
- 22 oz (651mL)



GROUT COATING

No. 143-1068

- Seals, waterproofs, and whitens tile grout, and resists mildew
- Biodegradable
- 8 oz (237mL)



TILE AND GROUT BRUSH

No. 142-1510

- May be used with (No. 143-1067) tile and grout cleaner
- 2 threaded holes for accepting extension pole at 2 different angles
- 7⅞" (200mm) long
- 1" (25mm) high white nylon bristles
- White polypropylene handle



SPILL CLEAN-UP POWDER

Dry formula quickly and effectively absorbs liquid spills, including fats, oils, and grease. Safe and non-toxic.

No. 159-1097

- Cleans 24 eight ounce (237mL) spills
- Meets OSHA and FDA requirements
- 6 qt (6L) container

FOOD GRADE LUBRICANT DISPLAY



No. 143-1107

- Includes 12 cans of Food Grade Lubricants:
 - 4 cans of Food Grade Grease (No. 143-1102)
 - 4 cans of Food Grade Oil (No. 143-1103)
 - 4 cans of Food Grade Silicone (No. 143-1104)
- Pre-assembled Point of Purchase display



Aerosol cans cannot ship by air.

LUBRICANTS

FOOD GRADE SILICONE SPRAY

No. 143-1104

- Ideal for foodservice equipment
- Rated from -40° to 285°F (-40° to 141°C)
- 11 oz (311g)



HIGH TEMPERATURE LUBRICANT

No. 189-1043

- Fire resistant
- Withstands temperatures to 540°F (282°C)
- 4 oz (118ml) bottle



SILICONE RELEASE AGENT SPRAY

No. 143-1061

- Ideal for foodservice equipment
- Colorless, heat stable and unaffected by water
- USDA authorized
- Rated from 350° to 600°F (177° to 316°C)
- 20 oz (568g)



FOOD GRADE GREASE SPRAY

No. 143-1102

- Ideal for foodservice equipment
- Rated from 0° to 450°F (18° to 232°C)
- 10 oz (283g)



FOOD GRADE SPRAY LUBRICANT

No. 143-1062

- Ideal for foodservice equipment
- Odorless, tasteless, non-toxic
- USDA authorized
- 9 oz (255g)



HIGH HEAT GRAPHITE GREASE

No. 143-1038

- Ideal for gas valves
- Resistant to breakdown caused by natural, LP and butane gases
- Withstands temperatures up to 185°F (85°C)
- 2 oz (57g) tube



FOOD GRADE OIL SPRAY

No. 143-1103

- Ideal for foodservice equipment
- Rated from -40° to 250°F (-40° to 121°C)
- 16 oz (453g)



FOOD GRADE LUBRICATING OIL

No. 143-1073

- For use on food processing and dairy machinery
- Colorless, odorless, tasteless, non-toxic
- USDA rated H1 for use in and around food processing areas
- 4 oz (118ml) squeeze bottle



FOOD GRADE GREASE

No. 143-1063

- Ideal for foodservice equipment
- Odorless, tasteless, non-toxic
- Rated from -15° to 210°F (-26° to 99°C)
- 4 oz (113g) tube



LUBRICATING SILICONE AEROSOL SPRAY

No. 143-1074

- Colorless, tasteless, and non-toxic
- USDA rated H1 for use in and around food processing areas
- 11 oz (311g) can



FOOD GRADE GREASE

No. 143-1064

- Ideal for foodservice equipment
- Odorless, tasteless, non-toxic
- Rated from -15° to 210°F (-26° to 99°C)
- 12 oz (340g) cartridge



HIGH TEMPERATURE FOOD GRADE GREASE

No. 143-1089

- Ideal for foodservice equipment
- Odorless, tasteless, non-toxic
- Rated from -10° to 500°F (-23° to 260°C)
- 14 oz (397g) cartridge



Aerosol cans cannot ship by air.